

Bluetooth® Audio System

Operating Instructions GB

Mode d'emploi FR

Owner's Record

The model and serial numbers are located on the bottom of the unit.
Record the serial number in the space provided below.
Refer to these numbers whenever you call upon your Sony dealer
regarding this product.

Model No. MEX-GS600BT Serial No. _____

To cancel the demonstration (DEMO) display, see page 7.
Pour annuler l'affichage de démonstration (DEMO), reportez-
vous à la page 7.



FM/AM Compact Disc Player

Operating Instructions GB

Mode d'emploi FR

Owner's Record

The model and serial numbers are located on the bottom of the unit.
Record the serial number in the space provided below.
Refer to these numbers whenever you call upon your Sony dealer
regarding this product.

Model No. CDX-GS500R Serial No. _____

To cancel the demonstration (DEMO) display, see page 6.
Pour annuler l'affichage de démonstration (DEMO), reportez-
vous à la page 5.



Be sure to install this unit in the dashboard of the car for safety. For installation and connections, see the supplied installation/connections manual.

Warning

FOR UNITED STATES CUSTOMERS. NOT APPLICABLE IN CANADA, INCLUDING IN THE PROVINCE OF QUEBEC.

POUR LES CONSOMMATEURS AUX ÉTATS-UNIS. NON APPLICABLE AU CANADA, Y COMPRIS LA PROVINCE DE QUÉBEC.

This equipment has been tested and found to comply with the limits for a Class B digital device, pursuant to Part 15 of the FCC Rules.

These limits are designed to provide reasonable protection against harmful interference in a residential installation. This equipment generates, uses, and can radiate radio frequency energy and, if not installed and used in accordance with the instructions, may cause harmful interference to radio communications. However, there is no guarantee that interference will not occur in a particular installation. If this equipment does cause harmful interference to radio or television reception, which can be determined by turning the equipment off and on, the user is encouraged to try to correct the interference by one or more of the following measures:

- Reorient or relocate the receiving antenna.
- Increase the separation between the equipment and receiver.
- Connect the equipment into an outlet on a circuit different from that to which the receiver is connected.
- Consult the dealer or an experienced radio/TV technician for help.

You are cautioned that any changes or modifications not expressly approved in this manual could void your authority to operate this equipment.

This device complies with Part 15 of the FCC Rules and Industry Canada licence-exempt RSS standard(s).

Operation is subject to the following two conditions: (1) this device may not cause harmful interference, and (2) this device must accept any interference received, including interference that may cause undesired operation of the device.

This transmitter must not be co-located or operated in conjunction with any other antenna or transmitter.

Under Industry Canada regulations, this radio transmitter may only operate using an antenna of a type and maximum (or lesser) gain approved for the transmitter by Industry Canada. To reduce potential radio interference to other users, the antenna type and its gain should be so chosen that the equivalent isotropically radiated power (e.i.r.p.) is not more than that necessary for successful communication.

This equipment complies with FCC/IC radiation exposure limits set forth for an uncontrolled environment and meets the FCC radio frequency (RF) Exposure Guidelines in Supplement C to OET65 and RSS-102 of the IC radio frequency (RF) Exposure rules. This equipment has very low levels of RF energy that it deemed to comply without maximum permissive exposure evaluation (MPE). But it is desirable that it should be installed and operated keeping the radiator at least 20 cm or more away from person's body (excluding extremities: hands, wrists, feet and ankles).

CAUTION

The use of optical instruments with this product will increase eye hazard.

For the State of California, USA only

Perchlorate Material – special handling may apply, See www.dtsc.ca.gov/hazardouswaste/perchlorate
Perchlorate Material: Lithium battery contains perchlorate



SiriusXM Connect Vehicle Tuner and Subscription sold separately.

www.siriusxm.com

Sirius, XM and all related marks and logos are trademarks of Sirius XM Radio Inc. All rights reserved.

The *Bluetooth* word mark and logos are owned by the Bluetooth SIG, Inc. and any use of such marks by Sony Corporation is under license. Other trademarks and trade names are those of their respective owners.

ZAPPIN and Quick-BrowZer are trademarks of Sony Corporation.

Windows Media is either a registered trademark or trademark of Microsoft Corporation in the United States and/or other countries.

This product is protected by certain intellectual property rights of Microsoft Corporation. Use or distribution of such technology outside of this product is prohibited without a license from Microsoft or an authorized Microsoft subsidiary.

iPhone, iPod, iPod classic, iPod nano, and iPod touch are trademarks of Apple Inc., registered in the U.S. and other countries. App Store is a service mark of Apple Inc.

MPEG Layer-3 audio coding technology and patents licensed from Fraunhofer IIS and Thomson.

Pandora, the Pandora logo, and the Pandora trade dress are trademarks or registered trademarks of Pandora Media, Inc., used with permission.

Android is a trademark of Google Inc. Use of this trademark is subject to Google Permissions.

BlackBerry® is the property of Research In Motion Limited and is registered and/or used in the U.S. and countries around the world. Used under license from Research In Motion Limited.

Note on the lithium battery

Do not expose the battery to excessive heat such as direct sunlight, fire or the like.

Warning if your car's ignition has no ACC position

Be sure to set the Auto Off function (page 35). The unit will shut off completely and automatically in the set time after the unit is turned off, which prevents battery drain. If you do not set the Auto Off function, press and hold **SOURCE/OFF** until the display disappears each time you turn the ignition off.

Table of contents

Getting Started	6
Notes on Bluetooth function	6
Canceling the DEMO mode	7
Setting the clock	7
Detaching the front panel	7
Location of controls	8
Main unit	8
RM-X231 Remote commander	10
Radio	11
Storing and receiving stations	11
RDS	12
CD	13
Playing a disc	13
USB devices	13
Playing back a USB device	13
iPod	14
Playing back iPod	14
Operating an iPod directly — Passenger control	15
Pandora® via USB (iPhone)	16
Streaming Pandora®	16
App Remote via USB (iPhone)	17
Two-way Music Control with iPhone	17
Searching and playing tracks	18
Playing tracks in various modes	18
Searching a track by name — Quick-BrowZer™	19
Searching a track by listening to track passages — ZAPPIN™	20
Changing the illumination	20
Changing the color of display and buttons — Dynamic Color Illuminator	20
Advanced color setting	21
Connecting Bluetooth devices	22
Bluetooth operations	22
Pairing	23
Connection	24
Handsfree calling	26
Music streaming	29
Initializing Bluetooth Settings	30

Pandora® via Bluetooth wireless technology
(Android™ & BlackBerry® phones) 30
 Streaming Pandora® 30

App Remote via Bluetooth wireless technology (Android phone) 32
 Two-way Music Control with Android phone 32

Sound Settings and Setup Menu. 33
 Enjoying sophisticated sound functions — Advanced Sound Engine 33
 Adjusting setup items 35

Using optional equipment. 38
 Auxiliary audio equipment 38
 SiriusXM Vehicle Tuner 39

Additional Information 40
 Precautions 40
 Maintenance 42
 Specifications. 43
 Troubleshooting 44

Getting Started

Notes on Bluetooth function

Caution

IN NO EVENT SHALL SONY BE LIABLE FOR ANY INCIDENTAL, INDIRECT OR CONSEQUENTIAL DAMAGES OR OTHER DAMAGES INCLUDING, WITHOUT LIMITATION, LOSS OF PROFITS, LOSS OF REVENUE, LOSS OF DATA, LOSS OF USE OF THE PRODUCT OR ANY ASSOCIATED EQUIPMENT, DOWNTIME, AND PURCHASER'S TIME RELATED TO OR ARISING OUT OF THE USE OF THIS PRODUCT, ITS HARDWARE AND/OR ITS SOFTWARE.

IMPORTANT NOTICE!

Safe and efficient use

Changes or modifications to this unit not expressly approved by Sony may void the user's authority to operate the equipment. Please check for exceptions, due to national requirement or limitations, in usage of Bluetooth equipment before using this product.

Driving

Check the laws and regulations on the use of cellular phones and handsfree equipment in the areas where you drive. Always give full attention to driving and pull off the road and park before making or answering a call if driving conditions so require.

Connecting to other devices

When connecting to any other device, please read its user guide for detailed safety instructions.

Radio frequency exposure

RF signals may affect improperly installed or inadequately shielded electronic systems in cars, such as electronic fuel injection systems, electronic antiskid (antilock) braking systems, electronic speed control systems or air bag systems. For installation or service of this device, please consult with the manufacturer or its representative of your car. Faulty installation or service may be dangerous and may invalidate any warranty that may apply to this device.

Consult with the manufacturer of your car to ensure that the use of your cellular phone in the car will not affect its electronic system. Check regularly that all wireless device equipment in your car is mounted and operating properly.

Emergency calls

This Bluetooth car handsfree and the electronic device connected to the handsfree operate using radio signals, cellular, and landline networks as well as user-programmed function, which cannot guarantee connection under all conditions.

Therefore do not rely solely upon any electronic device for essential communications (such as medical emergencies).

Remember, in order to make or receive calls, the handsfree and the electronic device connected to the handsfree must be switched on in a service area with adequate cellular signal strength.

Emergency calls may not be possible on all cellular phone networks or when certain network services and/or phone features are in use.

Check with your local service provider.

Canceling the DEMO mode

You can cancel the demonstration display which appears while this unit is turned off.

- 1 Press **(MENU)**, rotate the control dial until “DISPLAY” appears, then press it.
- 2 Rotate the control dial until “DEMO” appears, then press it.
- 3 Rotate the control dial to select “DEMO-OFF,” then press it.
The setting is complete.
- 4 Press **(BACK)** to return to the previous display.
The display returns to normal reception/play mode.

Setting the clock

The clock uses a 12-hour digital indication.

- 1 Press **(MENU)**, rotate the control dial until “GENERAL” appears, then press it.
- 2 Rotate the control dial until “CLOCK-ADJ” appears, then press it.
The hour indication flashes.
- 3 Rotate the control dial to set the hour and minute.
To move the digital indication, press **(SEEK) +/-**.
- 4 After setting the minute, press **(MENU)**.
The setup is complete and the clock starts.

To display the clock, press **(DSPL)**.

Detaching the front panel

You can detach the front panel of this unit to prevent theft.

- 1 Press and hold **(SOURCE/OFF)** ①.
The unit is turned off.
- 2 Press the front panel release button ②, then remove the panel by pulling it towards you.

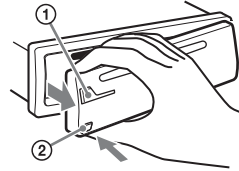

Caution alarm

If you turn the ignition switch to the OFF position without detaching the front panel, the caution alarm will sound for a few seconds. The alarm will only sound if the built-in amplifier is used.

Note

Do not subject the front panel to heat/high temperature or moisture. Avoid leaving it in a parked car or on a dashboard/rear tray.

Attaching the front panel

Engage part ① of the front panel with part ② of the unit, as illustrated, and push the left side into position until it clicks.

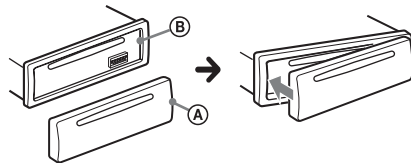

Location of controls

Main unit

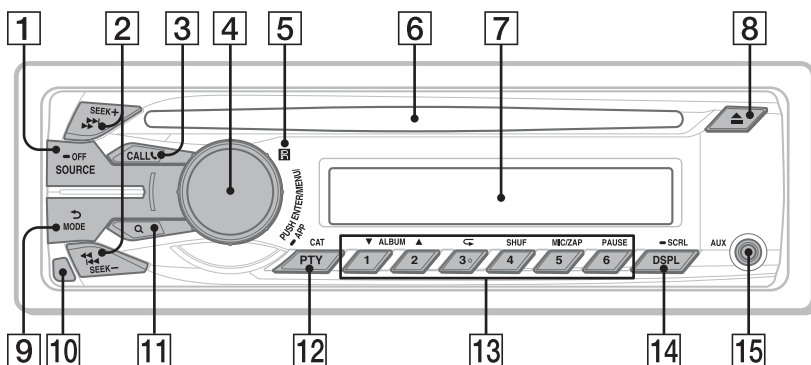

This section contains instructions on the location of controls and basic operations.

- 1 SOURCE/OFF button***1*2*3*4

Press to turn on the power; select the source (Radio/CD/USB/Pandora® via USB/AUX/Bluetooth audio/Bluetooth Pandora®/Bluetooth phone). Press repeatedly to change to another source.

Press and hold for 1 second to turn off the power.

Press and hold for more than 2 seconds to turn off the power and the display disappears.
- 2 SEEK +/- buttons**

Radio:
To tune in stations automatically (press); find a station manually (press and hold).

CD/USB:
To skip a track (press); skip tracks continuously (press, then press again within about 2 seconds and hold); reverse/fast-forward a track (press and hold).

Pandora® via USB/Bluetooth Pandora®:

To skip a track (press (SEEK) +).

Bluetooth Audio*5:

To skip a track (press); reverse/fast-forward a track (press and hold).

App Remote*6:

To skip a track (press).

- 3 CALL button** page 23

To enter the call menu (press); switch the Bluetooth signal (press and hold more than 2 seconds); receive/end a call (press).
- 4 Control dial/ENTER/MENU/APP button** page 17, 32, 35

Rotate to adjust volume.

Press to enter setup mode.

Press to receive/end a call.

Press and hold for more than 2 seconds to establish App Remote.

After pressing (SOURCE/OFF), rotate then press to change the source.
- 5 Receptor for the remote commander**

6 Disc slot
Insert the disc (label side up), playback starts.

7 Display window

8 ▲ (Eject) button
To eject the disc.

9 ↶ (BACK)/MODE button*¹ page 11, 15, 17, 27, 31

Press to return to the previous display; select the radio band (FM/AM).

Press and hold to enter/cancel the passenger control (iPod); enter the bookmark mode (Pandora® via USB/Bluetooth Pandora®).

Press to activate/deactivate the appropriate device (this unit/cellular phone) (Bluetooth phone).

10 Front panel release button page 7

11 Q (BROWSE) button page 16, 19, 31
To enter the Quick-BrowZer™ mode (CD/USB); list the station (Pandora® via USB/Bluetooth Pandora®).

12 PTY (Program Type)/CAT (Category)*⁷ button page 12, 39
To select PTY in RDS.

13 Number buttons
Radio:

To receive stored stations (press); store stations (press and hold).

CD/USB:

① / ②: ALBUM ▼/▲ (during MP3/WMA/AAC playback)

To skip an album (press); skip albums continuously (press and hold).

③: ↶ (Repeat)*⁸ page 18

④: SHUF page 18

⑤: ZAP page 20

⑥: PAUSE

To pause playback. Press again to resume playback.

Pandora® via USB/Bluetooth

Pandora®:

① / ②: Thumbs down (▼)/up (▲)
(press and hold for 1 second) page 16, 31

⑥: PAUSE

To pause playback. Press again to resume playback.

Bluetooth Audio*⁵:

① / ②: ALBUM ▼/▲

③: ↶ (Repeat)*⁸ page 29

④: SHUF page 29

⑥: PAUSE

To pause playback. Press again to resume playback.

Bluetooth phone: page 27, 28

To call a stored phone number (press); to store a phone number as a preset (press and hold) (in the call menu).

⑤: MIC (during a call) page 27

To set the MIC gain (press); to select Echo Canceler/Noise Canceler mode (press and hold).

App Remote*⁶:

⑥: PAUSE

To pause playback. Press again to resume playback.

14 DSPL (Display)/SCRL (Scroll) button
page 12, 13, 14, 15, 16, 25, 29, 31, 39

To change display items (press); scroll a display item (press and hold).

15 AUX input jack page 38

*1 If a SiriusXM Vehicle Tuner is connected: when **(SOURCE/OFF)** is pressed, the connected device ("SIRIUSXM") will appear on the display. Press **(MODE)** to select the desired SiriusXM Vehicle Tuner band.

*2 If App Remote is established with iPhone/Android™ phone, the application name appears on the display when selecting the source.

*3 While running the "App Remote" application, "Pandora® via USB" and "Bluetooth Pandora®" do not appear on the list.

*4 Depending on the device connected to the USB port, Bluetooth Pandora® may not be available.

- *5 When a Bluetooth audio device (supports AVRCP of Bluetooth technology) is connected. Depending on the device, certain operations may not be available.
- *6 When App Remote is established with iPhone/Android phone. Depending on the application, certain operations may not be available.
- *7 When the SiriusXM Vehicle Tuner is connected.
- *8 This button has a tactile dot.

Note

If the unit is turned off and the display disappears, the unit cannot be operated with the remote commander unless **(SOURCE/OFF)** on the unit is pressed, or a disc is inserted to activate the unit first.

RM-X231 Remote commander

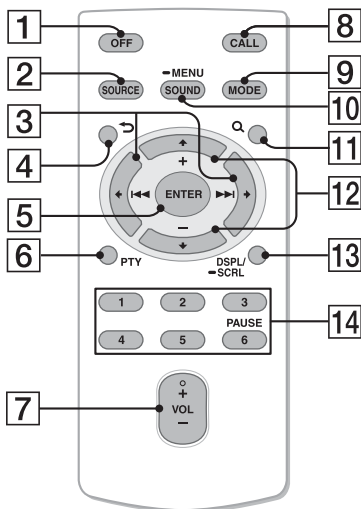

Remove the insulation film before use.

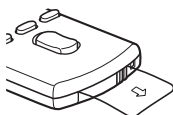

- 1 OFF button**
To turn off the power; stop the source; reject a call.
- 2 SOURCE button***1*2*3*4
Press to turn on the power.
Press repeatedly to change to another source (Radio/CD/USB/Pandora® via USB/AUX/Bluetooth audio/Bluetooth Pandora®/Bluetooth phone).
- 3 ◀ (◀◀)/▶ (▶▶) buttons**
To control Radio/CD/USB/Pandora® via USB/Bluetooth audio/Bluetooth Pandora®/App Remote, the same as **(SEEK) -/+** on the unit.
Setup items can be operated by **◀ ▶**.
After pressing **(SOURCE)**, press **◀ ▶** to change the source.
- 4 ↶ (BACK) button**
To return to the previous display.
- 5 ENTER button**
To apply a setting; receive a call; end a call.
- 6 PTY (Program Type) button**
- 7 VOL (Volume) +*5/- button**
- 8 CALL button**
To enter the call menu.
To receive/end a call.
- 9 MODE button***1
Press to select the radio band (FM/AM).
Press and hold to enter/cancel the passenger control; enter the bookmark mode (Pandora® via USB/Bluetooth Pandora®).
Press to activate/deactivate the appropriate device (this unit/cellular phone) (Bluetooth phone).
- 10 SOUND/MENU button**
To enter the SOUND menu directly (press); to enter setup mode (press and hold).
- 11 Q (BROWSE) button**

12 ↑ (+)/↓ (-) buttons

To control CD/USB/Pandora® via USB/Bluetooth audio device/Bluetooth Pandora®, the same as (1)/(2) (ALBUM ▼/▲) on the unit. Setup items can be operated by ↑ ↓.

13 DSPL (Display)/SCRL (Scroll) button

14 Number buttons

To receive stored stations (press); store stations (press and hold).

To call a stored phone number (press); to store a phone number as a preset (press and hold) (in the call menu) (Bluetooth phone).

To pause playback (press (6)).

- *1 If a SiriusXM Vehicle Tuner is connected: when (SOURCE) is pressed, the connected device (“SIRIUSXM”) will appear on the display. Press (MODE) to select the desired SiriusXM Vehicle Tuner band.
- *2 If App Remote is established with iPhone/Android phone, the application name appears on the display when selecting the source.
- *3 While running the “App Remote” application, “Pandora® via USB” and “Bluetooth Pandora®” do not appear on the list.
- *4 Depending on the device connected to the USB port, Bluetooth Pandora® may not be available.
- *5 This button has a tactile dot.

Radio

Storing and receiving stations

Caution

When tuning in stations while driving, use Best Tuning Memory (BTM) to prevent an accident.

Storing automatically — BTM

1 Press (SOURCE/OFF) repeatedly until “TUNER” appears.

To change the band, press (MODE) repeatedly. You can select from FM1, FM2, FM3, AM1 or AM2.

2 Press (MENU), rotate the control dial until “GENERAL” appears, then press it.

3 Rotate the control dial until “BTM” appears, then press it.

The unit stores stations in order of frequency on the number buttons.

Tip

You can also press (SOURCE/OFF), rotate the control dial to select “TUNER,” then press it to select the source.

Storing manually

1 While receiving the station that you want to store, press and hold a number button ((1) to (6)) until “MEM” appears.

Receiving the stored stations

- 1 Select the band, then press a number button (1 to 6).

Tuning automatically

- 1 Select the band, then press **(SEEK)** +/- to search for the station.

Scanning stops when the unit receives a station. Repeat this procedure until the desired station is received.

Tip

If you know the frequency of the station you want to listen to, press and hold **(SEEK)** +/- to locate the approximate frequency, then press **(SEEK)** +/- repeatedly to fine adjust to the desired frequency (manual tuning).

RDS

FM stations with Radio Data System (RDS) service send inaudible digital information along with the regular radio program signal.

Notes

- Depending on the country/region, not all RDS functions may be available.
- RDS will not work if the signal strength is too weak, or if the station you are tuned to is not transmitting RDS data.

Changing display items

Press **(DSPL)**.

Selecting PTY (Program Types)

Use PTY to display or search for a desired program type.

- 1 Press **(PTY)** during FM reception.
The current program type name appears if the station is transmitting PTY data.

- 2 Rotate the control dial until the desired program type appears, then press it.

The unit starts to search for a station broadcasting the selected program type.

Type of programs

NEWS (News), **INFORM** (Information), **SPORTS** (Sports), **TALK** (Talk), **ROCK** (Rock), **CLS ROCK** (Classic Rock), **ADLT HIT** (Adult Hits), **SOFT RCK** (Soft Rock), **TOP 40** (Top 40), **COUNTRY** (Country), **OLDIES** (Oldies), **SOFT** (Soft), **NOSTALGA** (Nostalgia), **JAZZ** (Jazz), **CLASSICL** (Classical), **R AND B** (Rhythm and Blues), **SOFT R B** (Soft Rhythm and Blues), **LANGUAGE** (Foreign Language), **REL MUSC** (Religious Music), **REL TALK** (Religious Talk), **PERSNLTY** (Personality), **PUBLIC** (Public), **COLLEGE** (College), **WEATHER** (Weather)

Note

You may receive a different radio program from the one you select.

Setting CT (Clock Time)

The CT data from the RDS transmission sets the clock.

- 1 Set "CT-ON" in setup (page 36).

Note

The CT function may not work properly even though an RDS station is being received.

CD

Playing a disc

This unit can play CD-DA (also containing CD TEXT) and CD-R/CD-RW (MP3/WMA/AAC files (page 40)).

1 Insert the disc (label side up).

Playback starts automatically.

To eject the disc, press ▲.

Notes

- When ejecting/inserting a disc, keep any USB devices disconnected to avoid damage to the disc.
- Corresponding codec is MP3 (.mp3), WMA (.wma) and AAC (.m4a).

Changing display items

Press (DSPL).

Displayed items may differ depending on the disc type, recording format and settings.

USB devices

- MSC (Mass Storage Class)-type USB devices (such as a USB flash drive, digital media player, Android phone) compliant with the USB standard can be used. Depending on the digital media player or Android phone, setting the USB connection mode to MSC is required.
- Backup of data to a USB device is recommended.

Notes

- Connect the USB device after starting the engine. Depending on the USB device, malfunction or damage may occur if it is connected before starting the engine.
- Corresponding codec is MP3 (.mp3), WMA (.wma), AAC (.m4a) and AAC (.mp4).
- For details on the compatibility of your USB device, visit the support site on the back cover.

Playing back a USB device

1 Connect the USB device to the USB port.

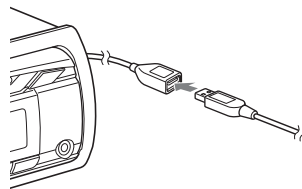

Playback starts.

If a USB device is already connected, to start playback, press (SOURCE/OFF) repeatedly until “USB” appears.

To stop playback, press and hold (SOURCE/OFF) for 1 second.

To remove the USB device, stop the USB playback, then remove the USB device.

Notes

- Do not use USB devices so large or heavy that they may fall down due to vibration, or cause a loose connection.
- Do not detach the front panel during playback of the USB device, otherwise USB data may be damaged.

Changing display items

Press **(DSPL)**.

Displayed items may differ depending on the USB device, recording format and settings.

Notes

- The maximum number of tracks is 10,000.
- It may take time for playback to begin, depending on the amount of recorded data.
- During playback or fast-forward/reverse of a VBR (Variable Bit Rate) MP3/WMA/AAC file, elapsed playing time may not display accurately.
- Playback of the following MP3/WMA/AAC files is not supported.
 - lossless compression files
 - copyright-protected files
 - DRM (Digital Rights Management) files
 - Multi-channel audio files

iPod

In these Operating Instructions, “iPod” is used as a general reference for the iPod functions on the iPod and iPhone, unless otherwise specified by the text or illustrations.

For details on the compatibility of your iPod, see “About iPod” (page 41) or visit the support site on the back cover.

Playing back iPod

Before connecting the iPod, turn down the volume of the unit.

1 Connect the iPod to the USB port with the USB connection cable for iPod (not supplied)*.

* RC-100IP USB connection cable for iPod is recommended.

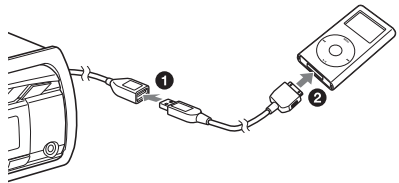

The tracks on the iPod start playing automatically from the point last played.

If an iPod is already connected, to start playback, press **(SOURCE/OFF)** repeatedly until “USB” appears. (“IPD” appears in the display when iPod is recognized.)

To stop playback, press and hold **(SOURCE/OFF)** for 1 second.

To remove the iPod, stop the iPod playback, then remove the iPod.

Caution for iPhone

When you connect iPhone via USB, phone call volume is controlled by iPhone, not the unit. Do not inadvertently increase the volume on the unit during a call, as sudden loud sound may result when the call ends.

Note

Do not detach the front panel during playback of the iPod, otherwise data may be damaged.

Tip

The iPod is recharged while the unit is turned on.

Resuming mode

When the iPod is connected to the unit, playback starts in the mode set by the iPod. In this mode, the following buttons do not function.

- (3) (↶)
- (4) (SHUF)

Changing display items

Press (DSPL).

Note

Some letters stored in iPod may not be displayed correctly.

Skipping albums, podcasts, genres, playlists and artists

To	Do this
Skip	Press (1)/(2) (ALBUM ▼/▲) [press once for each skip]
Skip continuously	Press and hold (1)/(2) (ALBUM ▼/▲) [hold to desired point]

Operating an iPod directly — Passenger control

You can operate an iPod directly even when it is connected to the unit.

1 During playback, press and hold

(MODE).

“MODE IPOD” appears and you will be able to operate the iPod directly.

To exit the passenger control, press and hold (MODE).

“MODE AUDIO” will appear and direct operation of the iPod will not be possible.

Note

The volume can be adjusted only by the unit.

Pandora® via USB (iPhone)

Pandora® is available to stream music through your iPhone. You can control Pandora® on a USB-connected iPhone from this unit.

Download the latest version of the Pandora® application and obtain more information from www.pandora.com

For details on usable devices, visit the support site on the back cover.

Notes

- Certain Pandora® service functions may not be available.
- The Pandora® service is only available in the U.S.

Streaming Pandora®

Before connecting the iPhone, turn down the volume of the unit.

1 Connect the iPhone to the USB port with a USB connection cable for iPhone (not supplied)*.

* RC-100IP USB connection cable for iPhone is recommended.

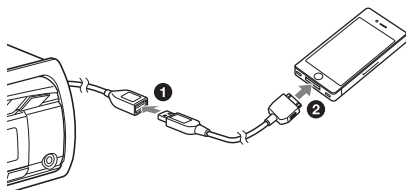

2 Press **SOURCE/OFF** repeatedly until “PANDORA USB” appears.

3 Launch Pandora® application on the iPhone.

4 Adjust the volume on this unit.

To pause playback, press **6** (PAUSE). To resume playback, press again.

To skip a track, press **SEEK** +.

Notes

- You cannot skip back to the previous track.
- Pandora® limits the number of skips allowed.

Changing display items

Press **DSPL**.

“Thumbs” feedback

“Thumbs Up” or “Thumbs Down” feedback allows you to personalize stations to suit your preference.

Thumbs Up

During playback, press and hold **2** (▲) for 1 second.

Thumbs Down

During playback, press and hold **1** (▼) for 1 second.

Station list

The station list allows you to easily select a desired station.

1 During playback, press **Q** (BROWSE).

2 Press **SEEK** + to select the sorting order “BY DATE” or “A TO Z.”

3 Rotate the control dial to select the desired station, then press it.

Playback starts.

Shuffle

Shuffle allows you to listen to tracks played on one or more Pandora® stations in your station list randomly. Edit your Shuffle station selections on the device before connection.

Bookmarking

The track or artist currently being played can be bookmarked and stored in your Pandora® account.

- 1 During playback, press and hold **MODE** until “BOOKMARK” appears.**
- 2 Rotate the control dial to select “TRK” (Track) or “ART” (Artist), then press it.**

App Remote via USB (iPhone)

Downloading the “App Remote” application from App StoreSM is required for iPhone.

If the application is downloaded to iPhone and connected to the unit, the following features are available:

- Operate the unit to launch and control compatible applications on iPhone.
- Operate iPhone with simple finger gestures to control the source of the unit.
- Display detailed source information (song title, artist name, album art, etc.) on iPhone.

Available operations differ depending on the application. For details on available applications, visit the support site on the back cover.

Notes

- For your safety, follow your local traffic laws and regulations, and do not operate the application while driving.
- The “App Remote” application via USB is only available for iPhones with iOS 5 installed.

Two-way Music Control with iPhone

- 1 Connect the iPhone to the USB port with a USB connection cable for iPhone (not supplied)*.**

* RC-100IP USB connection cable for iPhone is recommended.

- 2 Start up the “App Remote” application.**

3 Press and hold **(MENU)** (**APP**) on the unit for more than 2 seconds.

Connection to iPhone starts. When connection is established, the name of the application on iPhone appears when selecting a source, and some playback operations for the application become available. (Available operations differ depending on the application.) Likewise, some playback operations of the unit can be controlled by iPhone. For details on the operations on iPhone, see the help of the application.

Tip

You can also press **(MENU)**, rotate the control dial to select “APP REM,” then press it to establish the connection. And then press **(SOURCE/OFF)** to select the source.

To terminate connection

Press and hold **(MENU)**.

Searching and playing tracks

Playing tracks in various modes

You can listen to tracks repeatedly (repeat play) or in random order (shuffle play). Available play modes differ depending on the selected sound source.

1 During playback, press **(3)** (**↶**) or **(4)** (**SHUF**) repeatedly until the desired play mode appears.

Playback in selected play mode may take time to start.

Repeat play

Select	To play
↶ TRACK	track repeatedly.
↶ ALBUM	album repeatedly.
↶ PODCAST*1	podcast repeatedly.
↶ ARTIST*1	artist repeatedly.
↶ PLAYLIST*1	playlist repeatedly.
↶ GENRE*1	genre repeatedly.
↶ OFF	track in normal order (Normal play).

Shuffle play

Select	To play
SHUF ALBUM	album in random order.
SHUF DISC*2	disc in random order.
SHUF PODCAST*1	podcast in random order.
SHUF ARTIST*1	artist in random order.
SHUF PLAYLIST*1	playlist in random order.

SHUF GENRE* ¹	genre in random order.
SHUF DEVICE* ^{2,3}	device in random order.
SHUF OFF	track in normal order (Normal play).

*1 iPod only

*2 CD only

*3 USB and iPod only

Searching a track by name — Quick-BrowZer™

You can search for a track in a CD or USB device easily by category.

1 Press Q (BROWSE)*.

The unit enters the Quick-BrowZer mode, and the list of search categories appears.

When the track list appears, press  (BACK) repeatedly until the desired search category appears.

* During USB playback, press Q (BROWSE) for more than 2 seconds to directly return to the beginning of the category list.

2 Rotate the control dial to select the desired search category, then press it to confirm.

3 Repeat step 2 until the desired track is selected.

Playback starts.

To exit the Quick-BrowZer mode, press Q (BROWSE).

Notes

- When entering the Quick-BrowZer mode, the repeat/shuffle setting is canceled.
- “<Q” lights up when there is an upper layer, and “>Q” lights up when there is a lower layer.

Searching by skip items — Jump mode

When many items are in a category, you can search for a desired item quickly.

1 Press + in Quick-BrowZer mode.

The item name will appear.

2 Rotate the control dial to select the item near the one desired.



The list is skipped in steps of 10% of the total number of items in the list.

3 Press (ENTER).

The display returns to the Quick-BrowZer mode and the selected item appears.

4 Rotate the control dial to select the desired item and press it.

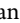
Playback starts if the selected item is a track.

To cancel Jump mode, press  (BACK) or  -.

Searching by alphabetical order — Alphabet search

When an iPod is connected to the unit, you can search for a desired item alphabetically.

1 Press + in Quick-BrowZer mode.

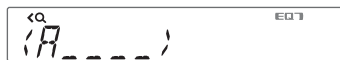

2 Rotate the control dial to select the first letter of the desired item, then press it.

A list of items beginning with the selected letter appears in alphabetical order.

3 Rotate the control dial to select the desired item, then press it.

Playback starts if the selected item is a track.

To cancel Alphabet search, press

↶ (BACK) or (SEEK) -.

Notes

- In Alphabet search, a symbol or article (a/an/the) before the selected letter of the item is excluded.
- Depending on the search item you select, only Jump mode may be available.
- Alphabet search may take some time, depending on the number of tracks.

Searching a track by listening to track passages — ZAPPIN™

By playing back short track passages in a CD or USB device in sequence, you can search for a track you want to listen to. ZAPPIN mode is suitable for searching for a track in shuffle or shuffle repeat mode.

1 Press (5) (ZAP) during playback.

Playback starts from a passage of the next track. You can select the playback time (page 36).

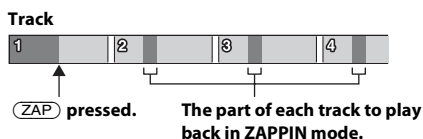

2 Press (MENU) (ENTER) or (5) (ZAP) when a track you want to listen is played back.

The track that you select returns to normal play mode from the beginning.

Pressing ↶ (BACK) will also play back the chosen track.

Tips

- Press (SEEK) +/- in ZAPPIN mode to skip a track.
- Press (1)/(2) (ALBUM ▼/▲) in ZAPPIN mode to skip an album.

Changing the illumination

Changing the color of display and buttons — Dynamic Color Illuminator

Dynamic Color Illuminator allows you to change the color of the display and buttons on the main unit to match the car's interior. You can select from 12 preset colors, customized color and 5 preset patterns.

Preset colors:

RED, AMBER, M_AMBER, YELLOW, WHITE, LIGHT GREEN, GREEN, LIGHT BLUE, SKY BLUE, BLUE, PURPLE, PINK.

Preset patterns:

RAINBOW, OCEAN, SUNSET, FOREST, RANDOM.

1 Press (MENU), rotate the control dial until "DISPLAY" appears, then press it.

2 Rotate the control dial until "COLOR" appears, then press it.

3 Rotate the control dial to select the desired preset color or pattern, then press it.

4 Press ↶ (BACK) to return to the previous display.

Note

If the control dial is rotated rapidly, the color of the display and the buttons may change too quickly.

Customizing the display and button color — Custom Color

You can register a customized color for the display and buttons.

- 1 Press **(MENU)**, rotate the control dial until “DISPLAY” appears, then press it.
- 2 Rotate the control dial until “CUSTOM-C” appears, then press it.
- 3 Rotate the control dial until “BASE” appears, then press it.
You can select a preset color as a basis for further customizing.
When you select “BASE,” the customized color is overwritten.
- 4 Rotate the control dial to select from “RGB RED,” “RGB GRN,” or “RGB BLUE,” then press it.
- 5 Rotate the control dial to adjust the color range, then press it.
Adjustable color range: “0” – “32.”
You cannot set “0” for all color ranges.
- 6 Press **↩** (BACK) to return to the previous display.

Changing DAY/NIGHT color mode

You can set a different color for DAY/NIGHT mode according to the dimmer setting.

Color mode	DIMMER*1
DAY	OFF or AUTO (turn off the head light*2)
NIGHT	ON or AUTO (turn on the head light*2)

*1 For details on the DIMMER, see page 37.

*2 Available only when the illumination control lead is connected.

- 1 Select “DAYNIGHT” in step 3 of “Customizing the display and button color — Custom Color.”

- 2 Select “DAY” or “NIGHT.”
- 3 Customize the preset color from step 3 to 5 of “Customizing the display and button color — Custom Color.”

Advanced color setting

Changing the color with sound synchronization — Sound Synchronization

When you select a preset pattern, sound synchronization becomes effective.

- 1 Press **(MENU)**, rotate the control dial until “DISPLAY” appears, then press it.
- 2 Rotate the control dial until “SND SYNC” appears, then press it.
- 3 Rotate the control dial to select “SYNC-ON,” then press it.
- 4 Press **↩** (BACK) to return to the previous display.

Displaying clear color — White Menu

You can display the menu more clearly (White) without concern for color setting.

- 1 Press **(MENU)**, rotate the control dial until “DISPLAY” appears, then press it.
- 2 Rotate the control dial until “WHT MENU” appears, then press it.
- 3 Rotate the control dial to select “WHITE-ON,” then press it.
- 4 Press **↩** (BACK) to return to the previous display.

To cancel White Menu, select “OFF” in step 3.

Start up effect

— Start White

In the Start White setting, when you press **(SOURCE/OFF)**, the display and buttons on the main unit turn white once, then change to the customized color.

- 1** Press **(MENU)**, rotate the control dial until “DISPLAY” appears, then press it.
- 2** Rotate the control dial until “START-WHT” appears, then press it.
- 3** Rotate the control dial to select “WHITE-ON,” then press it.
- 4** Press **↩** (BACK) to return to the previous display.

To cancel Start White, select “OFF” in step 3.

Connecting Bluetooth devices

Bluetooth operations

The Bluetooth function allows for handsfree calling and music streaming via this unit. To use the Bluetooth function, the following procedure is necessary.

① Pairing

When connecting Bluetooth devices for the first time, mutual registration is required. This is called “pairing.” Registration is required only for the first time, as this unit and the other devices will recognize each other automatically thereafter.

② Connection

To use the device after pairing is made, start the connection. Sometimes pairing allows for connection automatically.

③ Handsfree calling/Music streaming

You can make/receive handsfree calls and listen to music when the connection is made.

If pairing is not possible, your device may not be compatible with this unit. For details on compatible devices, visit the support site on the back cover.

Installing the microphone

To capture your voice during handsfree calling, you need to install the microphone (supplied).

For details on how to connect the microphone, refer to the supplied “Installation/Connections” guide.

Operating the Bluetooth functions

1 Press **CALL**.

The call menu appears.

2 Rotate the control dial until the desired item appears, then press it.

3 Press **BACK**.*

The source returns to the Bluetooth phone.

* For PAIRING, REDIAL, VOICE DIAL and BT SIGNAL settings, step 3 is not necessary.

The following items can be set:

PAIRING*¹ (page 23)

PHONEBOOK (page 26)

REDIAL (page 27)

RECENT CALL (page 26)

VOICE DIAL (page 28)

DIAL NUMBER (page 27)

RINGTONE*¹*²

Selects whether this unit or the connected cellular phone outputs the ringtone: “1 (this unit)”- “2 (cellular phone).”

AUTO ANS*¹ (Auto Answer)

Sets this unit to answer an incoming call automatically: “OFF”- “1 (about 3 seconds)”- “2 (about 10 seconds).”

BT SIGNAL*¹ (Bluetooth Signal) (page 24, 25)

BT INIT*³ (Bluetooth Initialize) (page 30)

*1 You can also select these items by pressing **MENU** and rotating the control dial to select “BT.”

*2 Depending on the cellular phone, this unit’s ringtone may be output even if set to “2 (cellular phone).”

*3 Appears on the setup menu when the unit is turned off.

Pairing

The Bluetooth device (cellular phone, audio device, etc.) and this unit need to be “paired” before use between each other via the Bluetooth function.

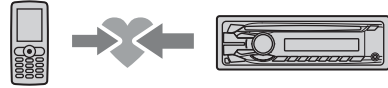

Tips

- For details on pairing for a Bluetooth device, refer to the operating instructions supplied with the device.
- You can pair up to 9 Bluetooth devices with this unit.

1 Place the Bluetooth device within 1 m (3 ft) of this unit.

2 Press **CALL** and rotate the control dial until “PAIRING” appears, then press it.

The unit enters pairing standby mode.

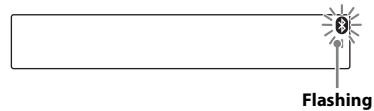

3 Set the Bluetooth device to search for this unit.

A list of detected devices appears in the display of the device to be connected. This unit is displayed as “Sony Automotive” on the device to be connected.

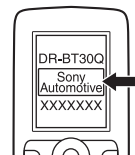

4 If passkey* input is required in the display of the device to be connected, input “0000.”

If the device supports Bluetooth version 2.1, passkey input is not required.

* Passkey may be called “passcode,” “PIN code,” “PIN number” or “Password,” etc., depending on the device.

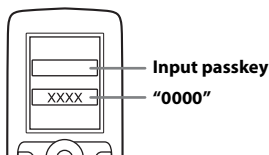



This unit and the Bluetooth device memorize each other’s information, and when pairing is made,  stays lit. The unit is ready for connection to the device.



Note

If “” continues to flash, the Bluetooth device may not be compatible with this unit. For details on compatible devices, visit the support site on the back cover.

5 Select this unit on the Bluetooth device to be connected.

“” or “” appears when the connection is made.

Notes

- While connecting to a Bluetooth device, this unit cannot be detected from another device. To enable detection, enter the pairing mode and search for this unit from another device.
- It may take time to search or connect.
- Depending on the device, the confirmation display of the connection appears before inputting the passkey.
- The time limit for inputting the passkey differs depending on the device. If the time expires, perform the pairing procedure from the beginning again.
- This unit cannot be connected to a device that supports only HSP (Head Set Profile).

Tip

Connection between this unit and the Bluetooth device may be automatic, depending on the device.

Canceling pairing

Perform step 2 to cancel the pairing mode after this unit and the Bluetooth device are paired.

Connection

To use the device after pairing is made, start the connection. Sometimes pairing allows for connection automatically.

If pairing has already been achieved, start operation from here.



Connecting a cellular phone

1 Press **CALL** and rotate the control dial until “BT SIGNL” appears, then press it.

“” lights up when Bluetooth signal is activated.



Note

When the Bluetooth signal for this unit is already ON, selecting “BT SIGNL” deactivates the Bluetooth signal.

Tip

You can also output the Bluetooth signal from this unit by pressing and holding **CALL** on this unit more than 2 seconds.



2 Turn on the cellular phone and activate the Bluetooth signal.

3 Connect to this unit using the cellular phone.

“” appears when the connection is made. If you select the Bluetooth phone source after the connection is made, the network name and the connected cellular phone name appear in the display.



Icons in the display:

	Signal strength status of connected cellular phone.*
	Remaining battery status of connected cellular phone.*

* Turns off without handsfree connection.
Differs depending on the cellular phone.

Changing display items

Press **(DSPL)**.

Connecting the last-connected cellular phone from this unit

- 1 Make sure the Bluetooth signal of the cellular phone is activated.
- 2 Press **(SOURCE/OFF)** repeatedly until “BT PHONE” appears.
- 3 Press **(MENU)** (ENTER).
“” flashes while the connection is being made, then stays lit while connected.

Notes

- Some cellular phones require permission to access their phonebook data during handsfree connection to this unit. Obtain permission via the cellular phone.
- While streaming Bluetooth audio, you cannot connect from this unit to the cellular phone. Connect from the cellular phone to this unit instead. A connecting noise may be heard over playback sound.

Tip

With Bluetooth signal on: when the ignition is turned on, this unit reconnects automatically to the last-connected cellular phone. But automatic connection also depends on the cellular phone's specification. If automatic connection is not made, connect manually.

Connecting an audio device

- 1 Press **(CALL)** and rotate the control dial until “BT SIGNL” appears, then press it.

“” lights up when Bluetooth signal is activated.



- 2 Turn on the audio device and activate the Bluetooth signal.

- 3 Connect to this unit using the audio device.

“” appears when the connection is made.



Connecting the last-connected audio device from this unit

- 1 Make sure the Bluetooth signal of the audio device is activated.
- 2 Press **(SOURCE/OFF)** repeatedly until “BT AUDIO” appears.
- 3 Press **(B)** (PAUSE).

“” flashes while the connection is being made, then stays lit while connected.

Handsfree calling

Once the unit is connected to the cellular phone, you can make/receive handsfree calls by operating this unit.



Before handsfree calling, check the following:

- 1 Make sure that “” and “” appear in the display.
- 2 If “” and “” do not appear, perform the connection procedure (page 24).
- 3 If you cannot connect this unit and the cellular phone via the Bluetooth function, perform the pairing procedure (page 23).

Receiving calls

When receiving a call, a ringtone is output from your car speakers or the connected cellular phone. The caller's name or phone number appears in the display.

- 1 Press **CALL** when a call is received with a ringtone.

The phone call starts.

Notes

- Depending on the cellular phone, the caller's name may appear.
- The ringtone and talker's voice are output only from the front speakers.

Rejecting a call

Press and hold **SOURCE/OFF** for 1 second.

Ending a call

Press **CALL** again.

Calling from the phonebook

When connecting to a cellular phone supporting PBAP (Phone Book Access Profile), you can access the phonebook, and make a call.

- 1 Press **CALL** and rotate the control dial until “PHONEBOOK” appears, then press it.
- 2 Rotate the control dial to select an initial from the initial list, and then press it.
- 3 Rotate the control dial to select a name from the name list, and then press it.
- 4 Rotate the control dial to select a number from the number list, and then press it.
The phone call starts.

Note

Depending on the cellular phone, contacts displayed on the unit may differ from the phonebook of the cellular phone.

Calling from the call history

When connecting to a cellular phone supporting PBAP (Phone Book Access Profile), you can access to the call history stored in the cellular phone, and make a call.

- 1 Press **CALL** and rotate the control dial until “RECENT CALL” appears, then press it.
A list of the call history appears.
- 2 Rotate the control dial to select a name or phone number from the call history, then press it.
The phone call starts.

Calling by phone number input

- 1 Press **CALL** and rotate the control dial until “DIAL NUMBER” appears, then press it.
- 2 Rotate the control dial to enter the phone number, and lastly select “ ” (space), then press **MENU** (ENTER)*. The phone call starts.

* To move the digital indication, press **SEEK** -/+.

Note

“_” appears instead of “#” on the display.

Calling by preset number

You can store up to 6 contacts in the preset dial. For details on how to store, see “Preset dial” (page 28).

- 1 Press **SOURCE/OFF**, rotate the control dial until “BT PHONE” appears, then press it.
- 2 Press a number button (① to ⑥) to select the contact you want to call.
- 3 Press **MENU** (ENTER). The phone call starts.

Calling by redial

- 1 Press **CALL** and rotate the control dial until “REDIAL” appears, then press it. The phone call starts.

Operations during a call

Presetting the volume of the ringtone and talker's voice

You can preset the volume level of the ringtone and talker's voice.

To adjust the ringtone volume:

Rotate the control dial while receiving a call. Ringtone volume can be adjusted.

To adjust the talker's voice volume:

Rotate the control dial during a call. The talker's voice volume can be adjusted.

Note

If the Bluetooth phone source is selected, rotating the control dial will only adjust the talker's volume.

Mic gain adjustment

You can adjust the volume for the other party. Press **5** (MIC) to adjust the volume levels (“MIC-LOW,” “MIC-MID,” “MIC-HI”).

EC/NC Mode (Echo Canceler/Noise Canceler Mode)

You can reduce echo and noise.

Press and hold **5** (MIC) to set to “EC/NC-1” or “EC/NC-2.”

Call transfer

In order to activate/deactivate the appropriate device (this unit/cellular phone), press **MODE** or use your cellular phone.

Notes

- For details on cellular phone operation, refer to your cellular phone manual.
- Depending on the cellular phone, handsfree connection may be cut off when call transfer is attempted.

Preset dial

You can store up to 6 contacts in the preset dial.

Notes

- If your cellular phone supports PBAP (Phone Book Access Profile), you can select a phone number from the phonebook or call history.
- Disconnecting the power supply lead will erase all the contacts in the preset dial.

1 Select a phone number that you want to store in the preset dial, from the phonebook, call history* or by inputting the phone number directly.

The phone number appears in the display of this unit.

* For the call history, you can also select from the caller name. In this case, the caller name appears in the display of this unit.

2 Press and hold a number button (1) to (6) to select the preset number to store until “MEM” appears.

The contact is stored in the selected preset number.

Voice dial activation

You can activate voice dialing with a cellular phone connected to this unit by saying the voice tag stored on the cellular phone, then make a call.

1 Press **CALL** and rotate the control dial until “VOICE DIAL” appears, then press it.

2 Say the voice tag stored on the cellular phone.

Your voice is recognized, and the call is made.

Notes

- Check that the unit and cellular phone are connected beforehand.
- Store a voice tag on your cellular phone beforehand.
- If you activate voice dialing with a cellular phone connected to this unit, this function may not always work in some cases.
- Voice dialing may not work in some situations, depending on the effectiveness of the cellular phone’s recognition function. For details, see the support site on the back cover.

Tip

Store voice tags while seated in the car, via this unit with “BT PHONE” source selected.

SMS indicator

While connecting a cellular phone to this unit, the SMS indicator informs you of any incoming or unread SMS messages.

If you receive a new SMS message, the SMS indicator flashes.



If there are any unread SMS messages, the SMS indicator stays lit.



Note

Function of the SMS indicator may depend on the cellular phone.

Music streaming

Listening to music from an audio device

You can listen to music from an audio device on this unit if the audio device supports A2DP (Advanced Audio Distribution Profile) of Bluetooth technology.



- 1 Turn down the volume on this unit.
- 2 Press **(SOURCE/OFF)** repeatedly until “BT AUDIO” appears.
- 3 Operate the audio device to start playback.
- 4 Adjust the volume on this unit.

Note

“BT AUDIO” does not appear in the display while running the “App Remote” application via the Bluetooth function.

Changing display items

Press **(DSPL)**.

Adjusting the volume level

The volume level is adjustable for any difference between the unit and the Bluetooth audio device.

- 1 Start playback of the Bluetooth audio device at a moderate volume.
- 2 Set your usual listening volume on the unit.
- 3 Press **(MENU)**, rotate the control dial until “SOUND” appears, then press it.

- 4 Rotate the control dial until “BTA VOL” appears, then press it.
- 5 Rotate the control dial to adjust the input level (“+18dB” – “0dB” – “– 8dB”), then press it.
- 6 Press **(BACK)** to return to the previous display.

Operating an audio device with this unit

You can perform the following operations on this unit if the audio device supports AVRCP (Audio Video Remote Control Profile) of Bluetooth technology. (The operation differs depending on the audio device.)

To	Do this
Skip albums	Press (1) / (2) (ALBUM ▼/▲) [press once for each album]
Repeat play	Press (3) (REP)* ¹
Shuffle play	Press (4) (SHUF)* ¹
Play	Press (6) (PAUSE)* ² on this unit.
Pause	Press (6) (PAUSE)* ² on this unit.
Skip tracks	Press (SEEK) -/+ (◀◀ / ▶▶) [press once for each track]
Reverse/ Fast-forward	Press and hold (SEEK) -/+ (◀◀ / ▶▶) [hold to desired point]

*1 Press repeatedly until the desired setting appears.

*2 Depending on the device, it may be necessary to press twice.

Operations other than the above should be performed on the audio device.

Notes

- Depending on the audio device, information, such as title, track number/time, playback status, etc., may not be displayed on this unit.

The information is displayed during Bluetooth audio playback only.

- Even if the source is changed on this unit, playback of the audio device does not stop.

Initializing Bluetooth Settings

You can initialize all the Bluetooth related settings (pairing information, preset number, device information, etc.) from this unit.

- 1 Press and hold (SOURCE/OFF) for 1 second to turn off the power.**
- 2 Press (MENU), rotate the control dial until "BT" appears, then press it.**
The menu list appears.
- 3 Rotate the control dial to select "BT INIT," then press it.**
The confirmation appears.
- 4 Rotate the control dial to select "INIT-YES," then press it.**
"INITIAL" flashes while initializing the Bluetooth settings; "COMPLETE" appears when initializing has finished.
- 5 Press ↵ (BACK) to return to the previous display.**

Note

When disposing of this unit, preset numbers should be deleted with "BT INIT."

Pandora® via Bluetooth wireless technology (Android™ & BlackBerry® phones)

Pandora® is available to stream music through your Android™ and BlackBerry® phones.

You can control Pandora® on Bluetooth connected Android and BlackBerry phone from this unit.

Download the latest version of the Pandora® application and obtain more information from

www.pandora.com

For details on usable devices, visit the support site on the back cover.

Notes

- Certain Pandora® service functions may not be available.
- You can control Pandora® via the Bluetooth function on Android and BlackBerry phones only.
- The Pandora® service is only available in the U.S.
- You cannot control Pandora® via the Bluetooth function while running the "App Remote" application via Bluetooth.

Streaming Pandora®

Before connecting the mobile device, turn down the volume of the unit.

- 1 Connect this unit and the mobile device via the Bluetooth function (page 22).**
- 2 Press (SOURCE/OFF) repeatedly until "BT PANDORA"™*1 appears.**
- 3 Launch Pandora® application on the mobile device.**

4 Press **(6)***2 (PAUSE) to start playback.

- *1 Does not appear, depending on the device connected to the USB port.
- *2 When the mobile device is connected, the device number may appear. Make sure that the same numbers are displayed (e.g., 123456) in this unit and the mobile device, then press **(MENU)** on this unit and select “Yes” on the mobile device.

To pause playback, press **(6)** (PAUSE). To resume playback, press again.

To skip a track, press **(SEEK)** +.

Notes

- You cannot skip back to the previous track.
- Pandora® limits the number of skips allowed.

Changing display items

Press **(DSPL)**.

Adjusting the volume level

The volume level of Pandora® is adjusted in the same way as a Bluetooth audio device.

For details, see page 29.

“Thumbs” feedback

“Thumbs Up” or “Thumbs Down” feedback allows you to personalize stations to suit your preference.

Thumbs Up

During playback, press and hold **(2)** (▲) for 1 second.

Thumbs Down

During playback, press and hold **(1)** (▼) for 1 second.

Station list

The station list allows you to easily select a desired station.

1 During playback, press **(Q)** (BROWSE).

2 Press **(SEEK)** + to select the sorting order “BY DATE” or “A TO Z.”

3 Rotate the control dial to select the desired station, then press it.

Playback starts.

Shuffle

Shuffle allows you to listen to tracks played on one or more Pandora® stations in your station list randomly.

Edit your Shuffle station selections on the device before connection.

Bookmarking

The track or artist currently being played can be bookmarked and stored in your Pandora® account.

1 During playback, press and hold **(MODE)** until “BOOKMARK” appears.

2 Rotate the control dial to select “TRK” (Track) or “ART” (Artist), then press it.

App Remote via Bluetooth wireless technology (Android phone)

Downloading the “App Remote” application from Google Play is required for Android phone.

If the application is downloaded to an Android phone and connected to the unit, the following features are available:

- Operate the unit to launch and control compatible applications on Android phone.
- Operate Android phone with simple finger gestures to control the source of the unit.
- Display detailed source information (song title, artist name, album art, etc.) on Android phone.
- Read out incoming text messages/SMS automatically.

Available operations differ depending on the application. For details on available applications, visit the support site on the back cover.

Notes

- For your safety, follow your local traffic laws and regulations, and do not operate the application while driving.
- The “App Remote” application via the Bluetooth function is only available for Android phones with Android 2.1, 2.2, 2.3 or 4.0 installed.
- Automatic reading of the SMS function is only available for Android phones with TTS Engine installed.
- You cannot control the “App Remote” application via the Bluetooth function while running Pandora® via Bluetooth.

Two-way Music Control with Android phone

Before connecting the mobile device, turn down the volume of the unit.

- 1 Connect this unit and the mobile device via the Bluetooth function (page 22).**
- 2 Start up the “App Remote” application.**
- 3 Press and hold (MENU) (APP) on the unit for more than 2 seconds.**

Connection to the mobile device starts. When connection is established, the name of the application on the mobile device appears when selecting a source, and some playback operations for the application become available. (Available operations differ depending on the application.)

Likewise, some playback operations of the unit can be controlled by the mobile device. For details on the operations on the mobile device, see the help of the application.

Note

When the mobile device is connected, the device number may appear. Make sure that the same numbers are displayed (e.g., 123456) in this unit and the mobile device, then press (MENU) on this unit and select “Yes” on the mobile device.

Tip

You can also press (MENU), rotate the control dial to select “APP REM,” then press it to establish the connection. And then press (SOURCE/OFF) to select the source.

To terminate connection

Press and hold (MENU).

Sound Settings and Setup Menu

Enjoying sophisticated sound functions — Advanced Sound Engine

Advanced Sound Engine creates an ideal in-car sound field with digital signal processing.

Selecting the sound quality — EQ7 Preset

You can select an equalizer curve from 7 equalizer curves (XPLOD, VOCAL, EDGE, CRUISE, SPACE, GRAVITY, CUSTOM or OFF).

- 1 During reception/playback, press **(MENU)**, rotate the control dial until “SOUND” appears, then press it.
- 2 Rotate the control dial until “EQ7 PRESET” appears, then press it.
- 3 Rotate the control dial until the desired equalizer curve appears, then press it.
- 4 Press **↵** (BACK) to return to the previous display.

To cancel the equalizer curve, select “OFF” in step 3.

Tip

The equalizer curve setting can be memorized for each source.

Customizing the equalizer curve — EQ7 Setting

“CUSTOM” of EQ7 allows you to make your own equalizer settings.

- 1 After selecting a source, press **(MENU)**, rotate the control dial until “SOUND” appears, then press it.
- 2 Rotate the control dial until “EQ7 SETTING” appears, then press it.
- 3 Rotate the control dial until “BASE” appears, then press it.
You can select an equalizer curve as a basis for further customizing.
- 4 Rotate the control dial to select the equalizer curve, then press it.
- 5 Setting the equalizer curve.
 - 1 Rotate the control dial to select the frequency range, then press it.



BAND1: 63 Hz
BAND2: 160 Hz
BAND3: 400 Hz
BAND4: 1 kHz
BAND5: 2.5 kHz
BAND6: 6.3 kHz
BAND7: 16.0 kHz

- 2 Rotate the control dial to adjust the volume level, then press it.
The volume level is adjustable in 1 dB steps, from -6 dB to +6 dB.

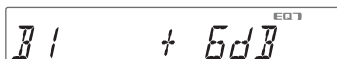

Repeat steps **1** and **2** to adjust other frequency ranges.

- 6 Press **↵** (BACK) to return to the previous display.

The equalizer curve is stored in “CUSTOM.”

Optimizing sound by Time Alignment — Listening Position

The unit can simulate a natural sound field by delaying the sound output from each speaker to suit your position.

The options for “POSITION” are indicated below.

- FRONT L (1)**: Front left
- FRONT R (2)**: Front right
- FRONT (3)**: Center front
- ALL (4)**: In the center of your car
- OFF**: No position set

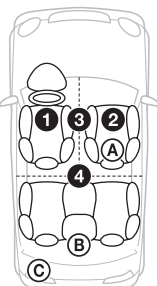

You can also set the approximate subwoofer position from your listening position if the listening position is set to other than “OFF.”

The options for “SET SW POS” are indicated below.

- NEAR (A)**: Near
- NORMAL (B)**: Normal
- FAR (C)**: Far

- 1** During reception/playback, press **(MENU)**, rotate the control dial until “SOUND” appears, then press it.
- 2** Rotate the control dial until “POSITION” appears, then press it.
- 3** Rotate the control dial until “SET F/R POS” appears, then press it.
- 4** Rotate the control dial to select from “FRONT L,” “FRONT R,” “FRONT” or “ALL,” then press it.
- 5** Rotate the control dial until “SET SW POS” appears, then press it.
- 6** Rotate the control dial to select the subwoofer position from “NEAR,” “NORMAL” or “FAR,” then press it.
- 7** Press **↩** (BACK) to return to the previous display.

To cancel listening position, select “OFF” in step 4.

Adjusting the listening position

You can fine-tune the listening position setting.

- 1** During reception/playback, press **(MENU)**, rotate the control dial until “SOUND” appears, then press it.
- 2** Rotate the control dial until “POSITION” appears, then press it.
- 3** Rotate the control dial until “ADJ POSITION” appears, then press it.
- 4** Rotate the control dial to adjust the listening position, then press it.
Adjustable range: “+3” – “CENTER” – “-3.”
- 5** Press **↩** (BACK) to return to the previous display.

DM+ Advanced

DM+ Advanced improves digitally compressed sound by restoring high frequencies lost in the compression process.

- 1** During playback, press **(MENU)**, rotate the control dial until “SOUND” appears, then press it.
- 2** Rotate the control dial until “DM+” appears, then press it.
- 3** Rotate the control dial to select “ON,” then press it.
- 4** Press **↩** (BACK) to return to the previous display.

Tip

The DM+ setting can be memorized for each source other than the tuner.

Using rear speakers as subwoofer — Rear Bass Enhancer

Rear Bass Enhancer enhances the bass sound by applying a low pass filter setting (page 37) to the rear speakers. This function allows the rear speakers to work as a subwoofer if one is not connected.

- 1 During reception/playback, press **(MENU)**, rotate the control dial until “SOUND” appears, then press it.
- 2 Rotate the control dial until “RB ENH” appears, then press it.
- 3 Rotate the control dial until “RBE MODE” appears, then press it.
- 4 Rotate the control dial to select from “1,” “2” or “3,” then press it.
- 5 Press **↩** (BACK) to return to the previous display.

Using a subwoofer without a power amplifier — Subwoofer Direct Connection

You can use the subwoofer without a power amplifier when it is connected to the rear speaker cord.

Note

Be sure to connect a 4 - 8 ohm subwoofer to either of the rear speaker cords. Do not connect a speaker to the other rear speaker cord.

- 1 During reception/playback, press **(MENU)**, rotate the control dial until “SOUND” appears, then press it.
- 2 Rotate the control dial until “SW DIREC” appears, then press it.
- 3 Rotate the control dial until “SW MODE” appears, then press it.

- 4 Rotate the control dial to select “1,” “2” or “3,” then press it.
- 5 Press **↩** (BACK) to return to the previous display.

For details on the settings for the subwoofer phase, position, low pass filter frequency and the low pass filter slope, see page 37.

Adjusting setup items

- 1 Press **(MENU)**, rotate the control dial until the desired category appears, then press it.
- 2 Rotate the control dial until the desired item appears, then press it.
- 3 Rotate the control dial to select the setting, then press it.*
The setting is complete.
- 4 Press **↩** (BACK) to return to the previous display.

* For CLOCK-ADJ and BTM settings, step 4 is not necessary.

The following items can be set depending on the source and setting:

GENERAL:

CLOCK-ADJ (Clock Adjust) (page 7)

CAUT ALM*₁ (Caution Alarm)

Activates the caution alarm: “ON,” “OFF” (page 7).

BEEP

Activates the beep sound: “ON,” “OFF.”

AUTO OFF

Shuts off automatically after a desired time when the unit is turned off: “NO,” “30S (Seconds),” “30M (Minutes),” “60M (Minutes).”

AUX-A^{*1*2} (AUX Audio)

Activates the AUX source display: “ON,” “OFF” (page 38).

CT (Clock Time)

Activates the CT function: “ON,” “OFF” (page 12).

BTM^{*3} (page 11)**ZAPPIN**^{*4}**ZAP TIME** (Zappin Time)

Selects the playback time for the ZAPPIN function.

- “Z.TIME-1 (about 6 seconds),”
- “Z.TIME-2 (about 15 seconds),”
- “Z.TIME-3 (about 30 seconds).”

ZAP BEEP (Zappin Beep)

Applies a beep sound between track passages: “ON,” “OFF.”

PARENTAL^{*5}

Sets the parental lock to “ON” or “OFF,” and edits the passcode (page 39).

*1 When the unit is turned off.

*2 Does not appear in App Remote.

*3 When the tuner is selected.

*4 When the CD or USB is selected.

*5 When the SiriusXM Vehicle Tuner is connected.

SOUND:

EQ7 PRESET (page 33)

EQ7 SETTING (page 33)

POSITION

SET F/R POS (Set Front/Rear Position)
(page 34)

ADJ POSITION^{*1} (Adjust Position)
(page 34)

SET SW POS^{*1} (Set Subwoofer Position)
(page 34)

BALANCE

Adjusts the sound balance: “RIGHT-15” – “CENTER” – “LEFT-15.”

FADER

Adjusts the relative level: “FRONT-15” – “CENTER” – “REAR-15.”

DM+^{*2} (page 34)

LOUDNESS (Dynamic Loudness)

Reinforces bass and treble for clear sound at low volume levels: “ON,” “OFF.”

ALO (Automatic Level Optimizer)

Adjust the playback volume level of all playback sources to the optimum level: “ON,” “OFF.”

RB ENH^{*3} (Rear Bass Enhancer)

RBE MODE (Rear Bass Enhancer Mode)

Selects the rear bass enhancer mode: “1,” “2,” “3,” “OFF.”

LPF FREQ (Low Pass Filter Frequency)

Selects the subwoofer cut-off frequency: “50Hz,” “60Hz,” “80Hz,” “100Hz,” “120Hz.”

LPF SLOP (Low Pass Filter Slope)

Selects the LPF slope: “1,” “2,” “3.”

SW DIREC^{*4} (Subwoofer Direct Connection)**SW MODE** (Subwoofer Mode)

Selects the subwoofer mode: “1,” “2,” “3,” “OFF.”

SW PHASE (Subwoofer Phase)

Selects the subwoofer phase: “NORM,” “REV.”

SW POS^{*1} (Subwoofer Position)
(page 34)

Selects the subwoofer position: “NEAR,” “NORMAL,” “FAR.”

LPF FREQ (Low Pass Filter Frequency)

Selects the subwoofer cut-off frequency: “50Hz,” “60Hz,” “80Hz,” “100Hz,” “120Hz.”

LPF SLOP (Low Pass Filter Slope)

Selects the LPF slope: “1,” “2,” “3.”

S.WOOFER (Subwoofer)**SW LEVEL** (Subwoofer Level)

Adjusts the subwoofer volume level:
“+10 dB” – “0 dB” – “-10 dB.”
(“ATT” is displayed at the lowest setting.)

SW PHASE (Subwoofer Phase)

Selects the subwoofer phase: “NORM,” “REV.”

SW POS*1 (Subwoofer Position)

Selects the subwoofer position: “NEAR,” “NORMAL,” “FAR.”

LPF FREQ (Low Pass Filter Frequency)

Selects the subwoofer cut-off frequency:
“50Hz,” “60Hz,” “80Hz,” “100Hz,” “120Hz.”

LPF SLOP (Low Pass Filter Slope)

Selects the LPF slope: “1,” “2,” “3.”

HPF (High Pass Filter)**HPF FREQ** (High Pass Filter Frequency)

Selects the front/rear speaker cut-off frequency: “OFF,” “50Hz,” “60Hz,” “80Hz,” “100Hz,” “120Hz.”

HPF SLOP (High Pass Filter Slope)

Selects the HPF slope (effective only when HPF FREQ is set to other than “OFF”): “1,” “2,” “3.”

AUX VOL*5 (AUX Volume Level)

Adjusts the volume level for each connected auxiliary equipment:
“+18 dB” – “0 dB” – “-8 dB.”

This setting negates the need to adjust the volume level between sources.

BTA VOL (Bluetooth Audio Volume Level)*6 (page 29)

*1 Does not appear when “SET F/R POS” is set to “OFF.”

*2 Does not appear when the tuner is selected.

*3 When “SW DIREC” is set to “OFF.”

*4 When “RBE MODE” is set to “OFF.”

*5 When the AUX is selected.

*6 When Bluetooth audio source is activated.

DISPLAY:**DEMO** (Demonstration)

Activates the demonstration: “ON,” “OFF.”

DIMMER

Changes the display brightness.

- “AT”: to dim the display automatically when you turn lights on. (Available only when the illumination control lead is connected.)
 - “ON”: to dim the display.
 - “OFF”: deactivate the dimmer.
-

COLOR (Preset Color)

Selects the preset color of the display and buttons on the main unit (page 20).

CUSTOM-C (Custom Color)

Selects a preset color as a basis for further customizing (page 21).

SND SYNC

Selects the color with sound synchronization: “ON,” “OFF” (page 21).

WHT MENU

Sets the effect when the source is switched: “ON,” “OFF” (page 21).

START-WHT

Sets the start up color: “ON,” “OFF” (page 22).

AUTO SCR* (Auto Scroll)

Scrolls long items automatically: “ON,” “OFF.”

* When the CD, USB, Pandora® via USB, Bluetooth audio or Bluetooth Pandora® is selected.

BT (Bluetooth):

For details on setup items for the Bluetooth settings, see page 23.

APP REM:

Start establishing App Remote.

Using optional equipment

Auxiliary audio equipment

By connecting an optional portable audio device to the AUX input jack (stereo mini jack) on the unit and then simply selecting the source, you can listen on your car speakers.

Connecting the portable audio device

- 1 Turn off the portable audio device.
- 2 Turn down the volume on the unit.
- 3 Connect the portable audio device to the unit with a connecting cord (not supplied)*.

* Be sure to use a straight type plug.

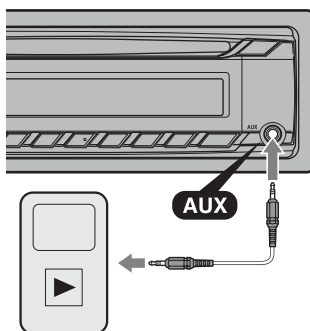

Adjusting the volume level

Be sure to adjust the volume for each connected audio device before playback.

- 1 Turn down the volume on the unit.
- 2 Press **(SOURCE/OFF)** repeatedly until "AUX" appears.
- 3 Start playback of the portable audio device at a moderate volume.
- 4 Set your usual listening volume on the unit.
- 5 Adjust the input level (page 37).

SiriusXM Vehicle Tuner

Everything worth listening to is on SiriusXM, getting over 130 channels, including the most commercial-free music, plus the best sports, news, talk and entertainment. A SiriusXM Vehicle Tuner (sold separately) and Subscription are required. For more information, visit www.siriusxm.com.

To listen to SiriusXM Satellite Radio, a subscription is required. Activate the SiriusXM Vehicle Tuner using one of the two methods below:

- Online: Go to www.siriusxm.com/activatenow
- Phone: Call 1-866-635-2349

For SiriusXM activation, the Radio ID is required.

Displaying the SiriusXM Radio ID

- 1 During playback, press **Q** (BROWSE) to enter the browse mode.
- 2 Rotate the control dial to select the channel “0,” then press it.

Note

To select “SIRIUSXM,” press **(SOURCE/OFF)** beforehand.

Selecting channels

- 1 Press **Q** (BROWSE) to enter the browse mode.
- 2 Rotate the control dial to select the desired channel, then press it.

Selecting channels from categories

- 1 Press **(PTY/CAT)** to enter browse mode.
- 2 Rotate the control dial to select the desired category, then press it.

Storing channels

- 1 While receiving the channel that you want to store, press and hold a number button (**(1)** to **(6)**) until “MEM” appears.

To receive the stored channel, select “SX1,” “SX2” or “SX3” by pressing **(MODE)**, then press a number button (**(1)** to **(6)**).

Parental control

Some SiriusXM channels contain content that is not suitable for children. You can enable a parental control passcode for these channels.

- 1 On the GENERAL menu (page 35), rotate the control dial to select “PARENTAL,” then press it.
- 2 Rotate the control dial to select “LOCK SEL,” then press it.
- 3 Rotate the control dial to select “LOCK-ON,” then press it.

To unblock the channels, select “OFF” in step 3, then enter the passcode. The initial passcode is “0000.”

Changing the passcode

- 1 On the GENERAL menu (page 35), rotate the control dial to select “PARENTAL,” then press it.
- 2 Rotate the control dial to select “CODE EDIT,” then press it.
- 3 On the current passcode input display, enter the current passcode, then press the control dial.
The initial passcode is “0000.”
- 4 On the new passcode input display, enter your new 4-digit passcode, then press the control dial.

Changing display items

Press **(DSPL)** to change as follows:
Channel Number (Default) → Channel Name → Artist Name → Song Title → Content Info → Category Name → Clock

Additional Information

Precautions

- Cool off the unit beforehand if your car has been parked in direct sunlight.
- Do not leave the front panel or audio devices brought in inside the car, or it may cause malfunction due to high temperature in direct sunlight.
- Power antenna (aerial) extends automatically.

Moisture condensation

Should moisture condensation occur inside the unit, remove the disc and wait for about an hour for it to dry out; otherwise the unit will not operate properly.

To maintain high sound quality

Do not splash liquid onto the unit or discs.

Notes on discs

- Do not expose discs to direct sunlight or heat sources such as hot air ducts, nor leave it in a car parked in direct sunlight.
- Before playing, wipe the discs with a cleaning cloth from the center out. Do not use solvents such as benzine, thinner, commercially available cleaners.
- This unit is designed to play back discs that conform to the Compact Disc (CD) standard. DualDiscs and some of the music discs encoded with copyright protection technologies do not conform to the Compact Disc (CD) standard, therefore, these discs may not be playable by this unit.



• Discs that this unit CANNOT play

- Discs with labels, stickers, or sticky tape or paper attached. Doing so may cause a malfunction, or may ruin the disc.
- Discs with non-standard shapes (e.g., heart, square, star). Attempting to do so may damage the unit.
- 8 cm (3 1/4 in) discs.

Notes on CD-R/CD-RW discs

- The maximum number of: (CD-R/CD-RW only)
 - folders (albums): 150 (including root folder)
 - files (tracks) and folders: 300 (may less than 300 if folder/file names contain many characters)
 - displayable characters for a folder/file name: 32 (Joliet)/64 (Romeo)
- If the multi-session disc begins with a CD-DA session, it is recognized as a CD-DA disc, and other sessions are not played back.
- **Discs that this unit CANNOT play**
 - CD-R/CD-RW of poor recording quality.
 - CD-R/CD-RW recorded with an incompatible recording device.
 - CD-R/CD-RW which is finalized incorrectly.
 - CD-R/CD-RW other than those recorded in music CD format or MP3 format conforming to ISO9660 Level 1/Level 2, Joliet/Romeo or multi-session.

Playback order of MP3/WMA/AAC files

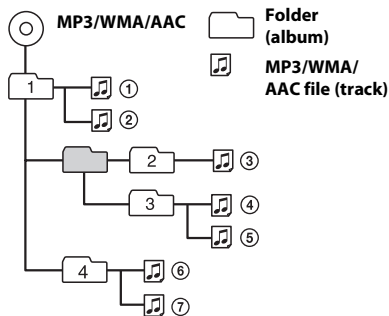

About iPod

- You can connect to the following iPod models. Update your iPod devices to the latest software before use.

Made for

- iPod touch (4th generation)
- iPod touch (3rd generation)
- iPod touch (2nd generation)
- iPod classic
- iPod nano (6th generation)
- iPod nano (5th generation)
- iPod nano (4th generation)
- iPod nano (3rd generation)
- iPod nano (2nd generation)
- iPod nano (1st generation)*
- iPhone 4S
- iPhone 4
- iPhone 3GS
- iPhone 3G

- * Passenger control is not available for iPod nano (1st generation).

- “Made for iPod” and “Made for iPhone” mean that an electronic accessory has been designed to connect specifically to iPod or iPhone respectively and has been certified by the developer to meet Apple performance standards. Apple is not responsible for the operation of this device or its compliance with safety and regulatory standards. Please note that the use of this accessory with iPod or iPhone may affect wireless performance.

About Bluetooth function

What is Bluetooth technology?

- Bluetooth wireless technology is a short-range wireless technology that enables wireless data communication between digital devices, such as a cellular phone and a headset. Bluetooth wireless technology operates within a range of about 10 m (about 33 feet). Connecting two devices is common, but some devices can be connected to multiple devices at the same time.

- You do not need to use a cable for connection since Bluetooth technology is a wireless technology, neither is it necessary for the devices to face one another, such is the case with infrared technology. For example, you can use such a device in a bag or pocket.
- Bluetooth technology is an international standard supported by millions of companies all over the world, and employed by various companies worldwide.

On Bluetooth communication

- Bluetooth wireless technology operates within a range of about 10 m. Maximum communication range may vary depending on obstacles (person, metal, wall, etc.) or electromagnetic environment.
- The following conditions may affect the sensitivity of Bluetooth communication.
 - There is an obstacle such as a person, metal, or wall between this unit and Bluetooth device.
 - A device using 2.4 GHz frequency, such as a wireless LAN device, cordless telephone, or microwave oven, is in use near this unit.
- Because Bluetooth devices and wireless LAN (IEEE802.11b/g) use the same frequency, microwave interference may occur and result in communication speed deterioration, noise, or invalid connection if this unit is used near a wireless LAN device. In such a case, perform the following.
 - Use this unit at least 10 m away from the wireless LAN device.
 - If this unit is used within 10 m of a wireless LAN device, turn off the wireless LAN device.
 - Install this unit and Bluetooth device as near to each other as possible.
- Microwaves emitting from a Bluetooth device may affect the operation of electronic medical devices. Turn off this unit and other Bluetooth devices in the following locations, as it may cause an accident.
 - where inflammable gas is present, in a hospital, train, airplane, or petrol station
 - near automatic doors or a fire alarm

- This unit supports security capabilities that comply with the Bluetooth standard to provide a secure connection when the Bluetooth wireless technology is used, but security may not be enough depending on the setting. Be careful when communicating using Bluetooth wireless technology.
- We do not take any responsibility for the leakage of information during Bluetooth communication.
- Connection with all Bluetooth devices cannot be guaranteed.
 - A device featuring Bluetooth function is required to conform to the Bluetooth standard specified by Bluetooth SIG, and be authenticated.
 - Even if the connected device conforms to the above mentioned Bluetooth standard, some devices may not be connected or work correctly, depending on the features or specifications of the device.
 - While talking on the phone hands free, noise may occur, depending on the device or communication environment.
- Depending on the device to be connected, it may require some time to start communication.

Others

- Using the Bluetooth device may not function on cellular phones, depending on radio wave conditions and location where the equipment is being used.
- If you experience discomfort after using the Bluetooth device, stop using the Bluetooth device immediately. Should any problem persist, consult your nearest Sony dealer.

If you have any questions or problems concerning your unit that are not covered in this manual, consult your nearest Sony dealer.

Maintenance

Replacing the lithium battery of the remote commander

When the battery becomes weak, the range of the remote commander becomes shorter. Replace the battery with a new CR2025 lithium battery. Use of any other battery may present a risk of fire or explosion.

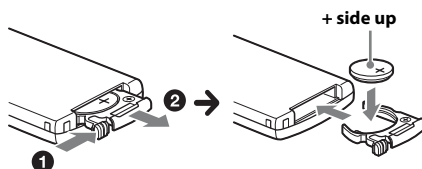

Notes on the lithium battery

- Keep the lithium battery out of the reach of children. Should the battery be swallowed, immediately consult a doctor.
- Wipe the battery with a dry cloth to assure a good contact.
- Be sure to observe the correct polarity when installing the battery.
- Do not hold the battery with metallic tweezers, otherwise a short-circuit may occur.

WARNING

Battery may explode if mistreated.
Do not recharge, disassemble, or dispose of in fire.

Cleaning the connectors

The unit may not function properly if the connectors between the unit and the front panel are not clean. In order to prevent this, detach the front panel (page 7) and clean the connectors with a cotton swab. Do not apply too much force. Otherwise, the connectors may be damaged.

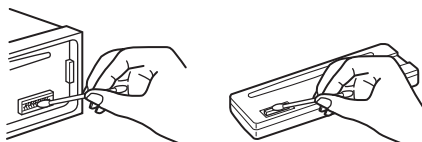

Notes

- For safety, turn off the ignition before cleaning the connectors, and remove the key from the ignition switch.
- Never touch the connectors directly with your fingers or with any metal device.

Specifications

FOR UNITED STATES CUSTOMERS. NOT APPLICABLE IN CANADA, INCLUDING IN THE PROVINCE OF QUEBEC.

POUR LES CONSOMMATEURS AUX ÉTATS-UNIS. NON APPLICABLE AU CANADA, Y COMPRIS LA PROVINCE DE QUÉBEC.

AUDIO POWER SPECIFICATIONS



CEA2006 Standard
Power Output: 17 Watts RMS \times 4 at 4 Ohms $<$ 1% THD+N
SN Ratio: 80 dBA
(reference: 1 Watt into 4 Ohms)

Tuner section

FM

Tuning range: 87.5 – 107.9 MHz

Antenna (aerial) terminal:

External antenna (aerial) connector

Intermediate frequency: 25 kHz

Usable sensitivity: 8 dBf

Selectivity: 75 dB at 400 kHz

Signal-to-noise ratio: 80 dB (stereo)

Separation: 50 dB at 1 kHz

Frequency response: 20 – 15,000 Hz

AM

Tuning range: 530 – 1,710 kHz

Antenna (aerial) terminal:

External antenna (aerial) connector

Intermediate frequency:

9,115 kHz or 9,125 kHz/5 kHz

Sensitivity: 26 μ V

CD Player section

Signal-to-noise ratio: 120 dB

Frequency response: 10 – 20,000 Hz

Wow and flutter: Below measurable limit

USB Player section

Interface: USB (Full-speed)

Maximum current: 1 A

Wireless Communication

Communication System:

Bluetooth Standard version 2.1 + EDR

Output:

Bluetooth Standard Power Class 2
(Max. +4 dBm)

Maximum communication range:

Line of sight approx. 10 m (33 ft)*1

Frequency band:

2.4 GHz band (2.4000 – 2.4835 GHz)

Modulation method: FHSS

Compatible Bluetooth Profiles*2:

A2DP (Advanced Audio Distribution Profile)

1.2

AVRCP (Audio Video Remote Control Profile)

1.3

HFP (Handsfree Profile) 1.5

PBAP (Phone Book Access Profile)

SPP (Serial Port Profile)

*1 The actual range will vary depending on factors such as obstacles between devices, magnetic fields around a microwave oven, static electricity, reception sensitivity, antenna (aerial)'s performance, operating system, software application, etc.

*2 Bluetooth standard profiles indicate the purpose of Bluetooth communication between devices.

Power amplifier section

Output: Speaker outputs

Speaker impedance: 4 – 8 ohms

Maximum power output: 52 W \times 4 (at 4 ohms)

General

Outputs:

Audio outputs terminal (front, rear, sub)

Power antenna (aerial)/Power amplifier control terminal (REM OUT)

Inputs:

SiriusXM input terminal

Remote controller input terminal

Antenna (aerial) input terminal

MIC input terminal

AUX input jack (stereo mini jack)

USB port

Power requirements: 12 V DC car battery
(negative ground (earth))

Dimensions: Approx. 178 \times 50 \times 177 mm
(7 ¹/₈ \times 2 \times 7 in) (w/h/d)

Mounting dimensions: Approx. 182 \times 53 \times 160 mm
(7 ¹/₄ \times 2 ¹/₈ \times 6 ⁵/₁₆ in) (w/h/d)

Mass: Approx. 1.2 kg (2 lb 11 oz)

Supplied accessories:

- Remote commander: RM-X231
- Microphone
- Parts for installation and connections (1 set)

Optional accessories/equipment:

- USB connection cable for iPod: RC-100IP
- SiriusXM Vehicle Tuner: SXV100

Your dealer may not handle some of the above listed accessories. Please ask the dealer for detailed information.

Design and specifications are subject to change without notice.

Troubleshooting

The following checklist will help you remedy problems you may encounter with your unit. Before going through the checklist below, check the connection and operating procedures.

For details on using the fuse and removing the unit from the dashboard, refer to the installation/connections manual supplied with this unit.

If the problem is not solved, visit the support site on the back cover.

General

No power is being supplied to the unit.

- Check the connection or fuse.
- If the unit is turned off and the display disappears, the unit cannot be operated with the remote commander.
 - Turn on the unit.

The power antenna (aerial) does not extend.

- The power antenna (aerial) does not have a relay box.

No sound.

- The ATT function is activated.
- The position of the fader control “FADER” is not set for a 2-speaker system.

No beep sound.

- The beep sound is canceled (page 35).
- An optional power amplifier is connected and you are not using the built-in amplifier.

The contents of the memory have been erased.

- The power supply lead or battery has been disconnected or not connected properly.
- The unit is reset.
 - Store again in the memory.

Stored stations and correct time are erased.

The fuse has blown.

Makes noise when the position of the ignition is switched.

- The leads are not matched correctly with the car’s accessory power connector.

During playback or reception, demonstration mode starts.

- If no operation is performed for 5 minutes with "DEMO-ON" set, demonstration mode starts.
 - Set "DEMO-OFF" (page 37).

The display disappears from/does not appear in the display window.

- The dimmer is set to "DIM-ON" (page 37).
- The display disappears if you press and hold **(SOURCE/OFF)**.
 - Press **(SOURCE/OFF)** on the unit until the display appears.
- The connectors are dirty (page 42).

The Auto Off function does not operate.

- The unit is turned on. The Auto Off function activates after turning off the unit.
 - Turn off the unit.

The operation buttons do not function.**The disc will not eject.**

- Press **(DSPL)** and **(BACK)/(MODE)** for more than 2 seconds.

The contents stored in memory are erased. For your safety, do not perform the reset operation while you are driving.

Radio reception**The stations cannot be received.****The sound is hampered by noises.**

- The connection is not correct.
 - Connect an REM OUT lead (blue/white striped) or accessory power supply lead (red) to the power supply lead of a car's antenna (aerial) booster (only when your car has built-in radio antenna (aerial) in the rear/side glass).
 - Check the connection of the car antenna (aerial).
 - If the auto antenna (aerial) will not go up, check the connection of the power antenna (aerial) control lead.

Preset tuning is not possible.

- Store the correct frequency in the memory.
- The broadcast signal is too weak.

Automatic tuning is not possible.

- The broadcast signal is too weak.
 - Perform manual tuning.

RDS**PTY displays "-------."**

- The current station is not an RDS station.
- RDS data has not been received.
- The station does not specify the program type.

CD playback**The disc cannot be loaded.**

- Another disc is already loaded.
- The disc has been forcibly inserted upside down or in the wrong way.

The disc does not play back.

- Defective or dirty disc.
- The CD-Rs/CD-RWs are not for audio use (page 40).

MP3/WMA/AAC files cannot be played back.

- The disc is incompatible with the MP3/WMA/AAC format and version. For details on playable discs and formats, visit the support site.

MP3/WMA/AAC files take longer to play back than others.

- The following discs take a longer time to start playback.
 - A disc recorded with a complicated tree structure.
 - A disc recorded in Multi Session.
 - A disc to which data can be added.

The display items do not scroll.

- For discs with very many characters, those may not scroll.
- "AUTO SCR" is set to "OFF."
 - Set "A.SCR-ON" (page 37).
 - Press and hold **(DSPL)** (SCRL).

The sound skips.

- Installation is not correct.
 - Install the unit at an angle of less than 45° in a sturdy part of the car.
- Defective or dirty disc.

USB playback

You cannot play back items via a USB hub.

- This unit cannot recognize USB devices via a USB hub.

Cannot play back items.

- A USB device does not work.
 - Connect it again.

A USB device takes longer to play back.

- The USB device contains files with a complicated tree structure.

The sound is intermittent.

- The sound may be intermittent at a high-bit-rate of more than 320 kbps.

Pandora® connection is not possible.

- Shut down Pandora® application on the mobile device, and then launch again.

Application name is mismatched with the actual application in App Remote.

- Launch the application again from the “App Remote” application.

Bluetooth function

The connecting device cannot detect this unit.

- Before the pairing is made, set this unit to pairing standby mode.
- While connected to a Bluetooth device, this unit cannot be detected from another device.
 - Disconnect the current connection and search for this unit from another device.
- When the device pairing is made, set the Bluetooth signal output to on (page 23, 24, 25).

Connection is not possible.

- The connection is controlled from one side (this unit or Bluetooth device), but not both.
 - Connect to this unit from a Bluetooth device or vice versa.
- Check the pairing and connection procedures in the manual of the other device, etc., and perform the operation again.

The name of the detected device does not appear.

- Depending on the status of the other device, it may not be possible to obtain the name.

No ringtone.

- Adjust the volume by rotating the control dial while receiving a call.
- Depending on the connecting device, the ringtone may not be sent properly.
 - Set “RINGTONE” to “1” (page 23).
- The front speakers are not connected to the unit.
 - Connect the front speakers to the unit. The ringtone is output only from the front speakers.

The talker’s voice volume is low.

- Adjust the volume level.

The talker’s voice cannot be heard.

- The front speakers are not connected to the unit.
 - Connect the front speakers to the unit. The talker’s voice is output only from the front speakers.

A call partner says that the volume is too low or high.

- Adjust the volume accordingly using mic gain adjustment (page 27).

Echo or noise occurs in phone call conversations.

- Lower the volume.
- Set EC/NC Mode to “EC/NC-1” or “EC/NC-2” (page 27).
- If the ambient noise other than the phone call sound is loud, try reducing this noise.
E.g.: If a window is open and road noise, etc., is loud, shut the window. If an air conditioner is loud, lower the air conditioner.

The phone is not connected.

- When Bluetooth audio is played, the phone is not connected even if you press **CALL**.
 - Connect from the phone.

The phone sound quality is poor.

- Phone sound quality depends on reception conditions of cellular phone.
 - Move your car to a place where you can enhance the cellular phone's signal if the reception is poor.

The volume of the connected audio device is low (high).

- Volume level will differ depending on the audio device.
 - Adjust the volume of the connected audio device or this unit.

No sound is heard from the Bluetooth audio device.

- The audio device is paused.
 - Cancel pause of the audio device.

The sound skips during playback of a Bluetooth audio device.

- Reduce the distance between the unit and the Bluetooth audio device.
- If the Bluetooth audio device is stored in a case which interrupts the signal, remove the audio device from the case during use.
- Several Bluetooth devices or other devices which emit radio waves are in use nearby.
 - Turn off the other devices.
 - Increase the distance from the other devices.
- The playback sound stops momentarily when the connection between this unit and the cellular phone is being made. This is not a malfunction.

The connected Bluetooth audio device cannot be controlled.

- Check that the connected Bluetooth audio device supports AVRCP.

Some functions do not work.

- Check if the connecting device supports the functions in question.

The name of the other party does not appear when a call is received.

- The calling phone is not set to send the phone number.

A call is answered unintentionally.

- The connecting phone is set to answer a call automatically.
- "AUTO ANS" of this unit is set to "ANS-1" or "ANS-2" (page 23).

Pairing failed due to time out.

- Depending on the connecting device, the time limit for pairing may be short.
 - Try completing the pairing within the time.

Bluetooth function cannot operate.

- Turn off the unit by pressing **(SOURCE/OFF)** for more than 2 seconds, then turn the unit on again.

No sound is output from the car speakers during handsfree call.

- If the sound is output from the cellular phone, set the cellular phone to output the sound from the car speakers.

Pandora® connection is not possible.

- Shut down the Pandora® application on the mobile device, and then launch again.

Application name is mismatched with the actual application in App Remote.

- Launch the application again from the "App Remote" application.

While running the "App Remote" application via Bluetooth, the display automatically switches to "BT AUDIO."

- The "App Remote" application or Bluetooth function has failed.
 - Run the application again.

Error displays/Messages

CHECKING

- The unit is confirming the connection of a USB device.
 - Wait until confirming the connection is finished.

ERROR

- The disc is dirty or inserted upside down.
 - Clean or insert the disc correctly.
- A blank disc has been inserted.

- The disc cannot play due to a problem.
 - Insert another disc.
- USB device was not automatically recognized.
 - Connect it again.
- Press **▲** to remove the disc.

FAILURE

- The connection of speakers/amplifiers is incorrect.
 - See the installation/connections manual of this model to check the connection.

HUB NO SUPRT (Hubs Not Supported)

- USB hub is not supported on this unit.

NO DEV (No Device)

- “USB” is selected as source without a USB device connected. A USB device or a USB cable has been disconnected during playback.
 - Be sure to connect a USB device and USB cable.

NO DISC

- The disc is ejected, or “CD” is selected as the source without inserting the disc.

NO MUSIC

- The disc or USB device does not contain a music file.
 - Insert a music CD in this unit.
 - Connect a USB device with a music file in it.

NO NAME

- A disc/album/artist/track name is not written in the track.

NOT FOUND

- There is no item beginning with the selected letter in Alphabet search.

OFFSET

- There may be an internal malfunction.
 - Check the connection. If the error indication remains on in the display, consult your nearest Sony dealer.

OVERLOAD

- USB device is overloaded.
 - Disconnect the USB device, then change the source by pressing **(SOURCE/OFF)**.
 - Indicates that the USB device is out of order, or an unsupported device is connected.

PUSH EJT (Push Eject)

- The disc cannot be ejected.
 - Press **▲** (eject) (page 9).

READ

- The unit is reading all track and album information on the disc.
 - Wait until reading is complete and playback starts automatically. Depending on the disc structure, it may take more than a minute.

USB NO SUPRT (USB Not Supported)

- The connected USB device is not supported.
 - For details on the compatibility of your USB device, visit the support site.

“LLLL” or “RRRR”

- During reverse or fast-forward, you have reached the beginning or the end of the disc and you cannot go any further.

“_”

- The character cannot be displayed with the unit.

For Bluetooth function:

BT BUSY (Bluetooth Busy)

- The phonebook and the call history of the cellular phone are not accessible from this unit.
 - Wait for a while, and then try again.

EMPTY

- The call history is empty.

ERROR

- BT Initialize failed.
- Phonebook access failed.
- Phonebook content was changed while accessing the cellular phone.
 - Access the phonebook in the cellular phone again.

MEM FAILURE (Memory Failure)

- This unit failed to store the contact in the preset dial.
 - Make sure that the number you intend to store is correct (page 28).

MEMORY BUSY

- This unit is storing data.
 - Wait until storing has finished.

NO DEV (No Device)

- Bluetooth audio source is selected without a Bluetooth audio device connected. A Bluetooth audio device has been disconnected during a call.
 - Be sure to connect a Bluetooth audio device.
- Bluetooth phone source is selected without a cellular phone connected. A cellular phone has been disconnected during a call.
 - Be sure to connect a cellular phone.

NO INFO (No Information)

- Network name and cellular phone name are not received with cellular phone connected.

P (preset number) EMPTY

- The preset dial is empty.

UNKNOWN

- Name or phone number cannot be displayed when browsing phonebook or call history.

WITHHELD

- Phone number is hidden by caller.

For App Remote operation:

APP ----- (Application)

- Connection with the application is not made.
 - Establish iPhone connection again.

APP MENU (Application Menu)

- Button operation cannot be performed while a menu on iPhone/Android phone is open.
 - Exit the menu on iPhone/Android phone.

APP NO DEV (Application No Device)

- The device with the application installed is not connected.
 - Connect the device, then establish iPhone connection.

OPEN APP (Open Application)

- The “App Remote” application is not running.
 - Start up the iPhone’s application.

For Pandora® operation:

CANNOT SKIP

- Skipping tracks on Pandora® is not allowed.
 - Wait until the commercial ends.
 - Pandora® limits the number of skips allowed on their service. Wait until the next track begins, or select another station on the list.

CHK DEV (Check Device)

- Pandora® does not start up.
 - Start up the Pandora® application and log into your account.

ERROR

- “Thumbs” feedback failed.
 - Try “Thumbs Up/Down” again.
- Bookmarking failed.
 - Try bookmarking again.

NO STATION

- There is no station on your Pandora® account.
 - Create the station on the mobile device.

NOT ALLOWED

- “Thumbs” feedback is not allowed.
 - Wait until the commercial ends.
 - Some functions, such as Shared Station, do not permit feedback. Wait until the next track begins, or select another station on the list.
- Bookmark is not allowed.
 - Wait until the commercial ends.
 - Select another track or station, then try it again.

OPEN APP (Open Application)

When connecting via the USB port.

- Pandora® does not start up.
 - Start up the Pandora® application on iPhone.

OPEN APP (Open Application), **PRESS PAUSE**

When connecting via the Bluetooth function.

- Pandora® does not start up.
 - Start up the Pandora® application on the mobile device, then press **(⏸)** (PAUSE).

PAN NO SUPRT (Pandora® Not Supported)

- The connected device is not supported.
 - For details on the compatibility of the device, visit the support site.

For SiriusXM operation:

CH LOCKD (Channel Locked)

- The selected channel is locked by the parental control function.
-

CH UNAVL (Channel Unavailable)

- The selected channel is not available.
 - The active channel has become unavailable.
-

CH UNSUB (Channel Unsubscribed)

- There is no subscription to the selected channel.
 - The subscription to the active channel has been terminated.
-

CHEK ANT (Check Antenna)

- The antenna (aerial) is not being used properly.
 - Make sure the antenna (aerial) is connected and being used properly.
-

CHK TUNR (Check Tuner)

- The SiriusXM Vehicle Tuner is not functioning properly.
 - Disconnect the SiriusXM Vehicle Tuner, and connect it again.
-

CODE ERROR

- Passcode inputs failed.
-

MEM FAILURE (Memory Failure)

- This unit failed to store the channel in the preset dial.
 - Make sure that the channel you intend to store is correct.
-

NOSIGNAL (No Signal)

- The service is stopped due to a signal interruption.
-

SUBSCRIPTION UPDATE - ENTER TO CONTINUE

- Your subscription has been updated.
 - Press **(MENU)**.

If these solutions do not help improve the situation, consult your nearest Sony dealer. If you take the unit to be repaired because of CD playback trouble, bring the disc that was used at the time the problem began.

Support site

If you have any questions or for the latest support information on this product, please visit the web site below:

Site d'assistance

Si vous avez des questions ou si vous souhaitez consulter les toutes dernières informations techniques sur ce produit, rendez-vous sur le site Web suivant :

<http://esupport.sony.com>

<http://www.sony.com/caraudio>

If you have any questions/problems regarding this product, try the following:

1 *Read Troubleshooting in these Operating Instructions.*

2 *Please contact (U.S.A. only);*

Call **1-800-222-7669**

URL **<http://www.SONY.com>**



Bluetooth® Audio System

Installation/Connections
Installation/Connexions

©2012 Sony Corporation Printed in Thailand <http://www.sony.net/>

MEX-GS600BT

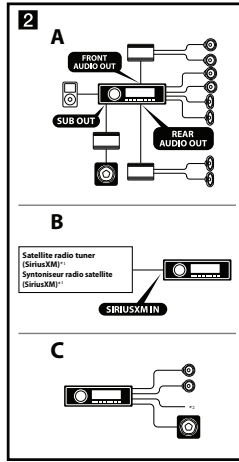
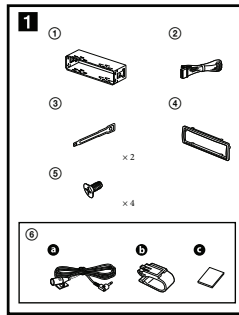

English

Cautions

Be sure to install this unit in the dashboard of the car as the rear side of the unit becomes hot during use.

This unit is designed for negative ground (earth) 12 V DC operation only.

Do not get the leads under a screw, or caught in moving parts (e.g. seat ralling).

Before making connections, turn the car ignition off to avoid short circuits.

Connect the yellow and red power supply leads only after all other leads have been connected.

Run all ground (earth) leads to a common ground (earth) point.

Be sure to insulate any loose unconnected leads with electrical tape for safety.

The use of optical instruments with this product will increase eye hazard.

Notes on the power supply lead (yellow)

- When connecting this unit in combination with other stereo components, the connected car circuit's rating must be higher than the sum of each component's fuse.
- When no car circuits are rated high enough, connect the unit directly to the battery.

Parts list

The numbers in the list are keyed to those in the instructions.

The bracket ① and the protection collar ② are attached to the unit before shipping. Before mounting the unit, use the release keys ③ to remove the bracket ① from the unit. For details, see "Removing the protection collar and the bracket ①" on the reverse side of the sheet.

Keep the release keys ③ for future use as they are also necessary if you remove the unit from your car.

Caution
Handle the bracket ① carefully to avoid injuring your fingers.

Connection example

Subwoofer Direct Connection (2-C)
For details on the setting for the connection, see the supplied Operating Instruction.

Notes

- Be sure to connect the ground (earth) lead before connecting the amplifier.
- The alarm will only sound if the built-in amplifier is used.

Connection diagram

- To a metal surface of the car**
First connect the black ground (earth) lead, then connect the yellow and red power supply leads.
- To the power antenna (aerial) control lead or power supply lead of antenna (aerial) booster**
Notes
 - If it is not necessary to connect this lead there is no power antenna (aerial) or antenna (aerial) booster, or with a manually-operated telescopic antenna (aerial).
 - When your car has a built-in FM/AM antenna (aerial) in the rear/side glass, see "Notes on the control and power supply leads."
- AMP REMOTE IN of an optional power amplifier**
This connection is only for amplifiers and a power antenna (aerial). Connecting any other system may damage the unit.
- To a car's illumination signal**
Be sure to connect the black ground (earth) lead to a metal surface of the car first.
- To the +12 V power terminal which is energized in the accessory position of the ignition switch**
Notes
 - If there is no accessory position, connect to the +12 V power (battery) terminal which is energized at all times.
 - Be sure to connect the black ground (earth) lead to a metal surface of the car first.
 - When your car has a built-in FM/AM antenna (aerial) in the rear/side glass, see "Notes on the control and power supply leads."
- To the +12 V power terminal which is energized at all times**
Be sure to connect the black ground (earth) lead to a metal surface of the car first.

Notes on the control and power supply leads

- REM OUT lead (blue/white striped) supplies +12 V DC when you turn on the unit.
- When your car has built-in FM/AM antenna (aerial) in the rear/side glass, connect REM OUT lead (blue/white striped) or the necessary power supply lead (red) to the power terminal of the existing antenna (aerial) booster. For details, consult your dealer.
- A power antenna (aerial) without a relay box cannot be used with this unit.

Memory hold connection
When the yellow power supply lead is connected, power will always be supplied to the memory circuit even when the ignition switch is turned off.

Notes on speaker connection

- Before connecting the speakers, turn the unit off.
- Use speakers with an impedance of 4 Ω or above, and with adequate power handling capacities to avoid its damage.
- Do not connect the speaker terminals to the car chassis, or connect the terminals of the right speakers with those of the left speaker.
- Do not connect the ground (earth) lead of this unit to the negative (-) terminal of the speaker.
- Do not attempt to connect the speakers in parallel.
- Connect only passive speakers. Connecting active speakers (with built-in amplifiers) to the speaker terminals may damage the unit.
- To avoid a malfunction, do not use the built-in speaker leads installed in your car if the unit shares a common negative (-) lead for the right and left speakers.
- Do not connect the unit's speaker leads to each other.

Note on connection
If speaker and amplifier are not connected correctly, "FALLURE" appears in the display. In this case, make sure the speaker and amplifier are connected correctly.

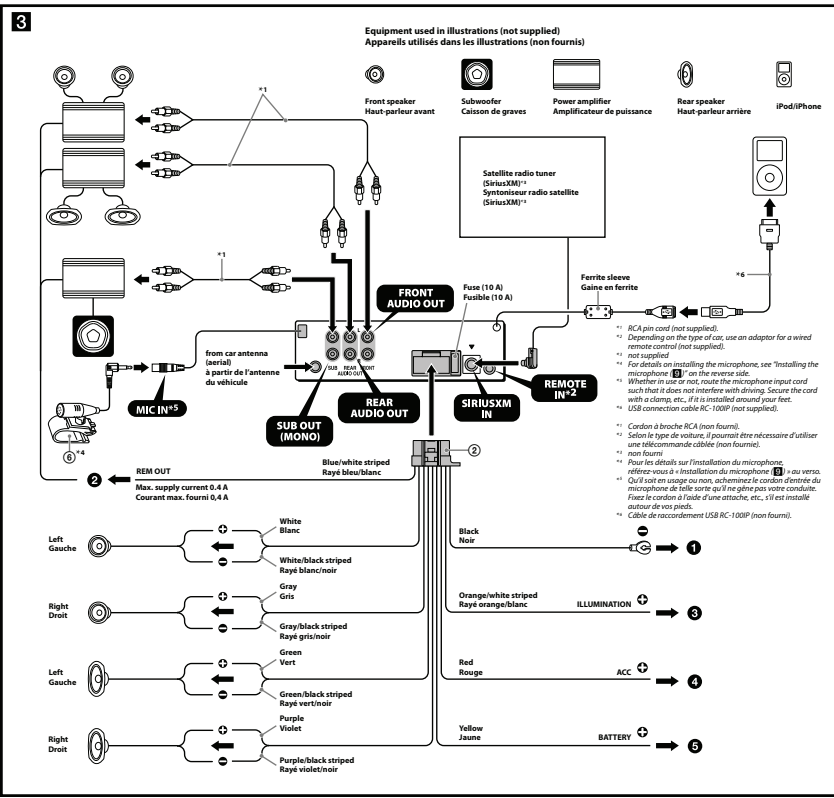

Français

Précautions

Installez cet appareil sur le tableau de bord de la voiture, car l'arrière de l'appareil chauffe en cours d'utilisation.

Cet appareil est exclusivement conçu pour fonctionner sur une tension de 12 V CC avec masse négative.

Évitez de fixer des vis sur les câbles ou de coincer ceux-ci dans des pièces mobiles (par exemple, armature de siège).

Avant d'effectuer les raccordements, coupez le moteur pour éviter un court-circuit.

Raccordez les câbles d'alimentation jaune et rouge seulement après avoir terminé tous les autres raccordements.

Rassemblez tous les câbles de mise à la masse en un point de masse commun.

Pour des raisons de sécurité, veillez à isoler avec du ruban isolant tout câble libre non raccordé.

L'utilisation d'instruments optiques avec ce produit augmente les risques pour les yeux.

Remarques sur le câble d'alimentation (jaune)

- Lorsque cet appareil est raccordé à d'autres éléments réseau, la valeur nominale du circuit de la voiture raccordé doit être supérieure à la somme des fusibles de chaque élément.
- Si aucun circuit de la voiture n'est assez puissant, raccordez directement l'appareil à la batterie.

Liste des composants

Les numéros de la liste correspondent à ceux des instructions.

Le support ① et le tour de protection ② sont fixés à l'appareil en usine. Avant le montage de l'appareil, utilisez les clés de déblocage ③ pour détacher le support ① de l'appareil. Pour de plus amples informations, reportez-vous à la section « Retrait du tour de protection et du support ① » au verso.

Conservez les clés de déblocage ③ pour une utilisation ultérieure, car vous en aurez également besoin pour retirer l'appareil de votre véhicule.

Attention
Manipulez le support ① avec soin pour éviter de vous blesser aux doigts.

Exemple de raccordement

Raccordement direct d'un caisson de graves (2-C)
Pour plus de détails sur le réglage pour le raccordement, reportez-vous au mode d'emploi fourni.

Notes

- Be sure to connect the ground (earth) lead before connecting the amplifier.
- The alarm will only sound if the built-in amplifier is used.

Schéma de raccordement

- À un point métallique de la voiture**
Branchez d'abord le câble de mise à la masse noir et, ensuite, les câbles d'alimentation jaune et rouge.
- À un câble de commande d'antenne électrique ou au câble d'alimentation de l'amplificateur d'antenne**
Remarques
 - Si n'y a pas de commande d'antenne électrique ou d'amplificateur d'antenne, ou avec une antenne électrique d'amplificateur d'antenne, ou avec une antenne électrique d'amplificateur d'antenne.
 - Si votre voiture est équipée d'une antenne FM/AM intégrée dans la vitre arrière latérale, voir « Remarques sur les câbles de commande d'alimentation ».
- Vers le connecteur du signal d'éclairage de la voiture**
Raccordez d'abord le câble de mise à la masse noir à un point métallique du véhicule.
- À la borne d'alimentation +12 V qui est alimentée quand la clé de contact est sur la position accessoires**
Remarques
 - Si n'y a pas de position accessoires, raccordez la borne d'alimentation (batterie) +12 V qui est alimentée en permanence.
 - Raccordez d'abord le câble de mise à la masse noir à un point métallique du véhicule.
 - Si votre voiture est équipée d'une antenne FM/AM intégrée dans la vitre arrière latérale, voir « Remarques sur les câbles de commande d'alimentation ».
- À la borne d'alimentation +12 V qui est alimentée en permanence**
Le câble REM OUT (rayé bleu/blanc) fournit un alimentement de +12 V CC lorsque votre voiture est en marche.

Remarques sur les câbles de commande et d'alimentation

- Le câble REM OUT (rayé bleu/blanc) fournit un alimentement de +12 V CC lorsque votre voiture est en marche.
- Lorsque votre voiture est équipée d'une antenne FM/AM intégrée dans la vitre arrière latérale, raccordez le câble REM OUT (rayé bleu/blanc) ou le câble d'alimentation des accessoires through à la borne d'alimentation de l'amplificateur d'antenne existant. Pour plus de détails, consultez votre détaillant.
- Une antenne électrique sans bobine de relais ne peut pas être utilisée avec cet appareil.

Raccordement pour la conservation de la mémoire
Lorsque le câble d'alimentation jaune est raccordé, le circuit de la mémoire est alimenté en permanence même si la clé de contact est sur la position éteint.

Remarques sur le raccordement des haut-parleurs

- Avant de raccorder les haut-parleurs, éteignez l'appareil.
- Utilisez des haut-parleurs ayant une impédance de 4 Ω ou plus avec une capacité électrique adéquate pour éviter de les endommager.
- Ne raccordez pas les bornes du système de haut-parleurs au chassis de la voiture et ne raccordez pas les bornes du haut-parleur droit à celles du haut-parleur gauche.
- Ne raccordez pas le câble de mise à la masse de cet appareil à la borne négative (-) du haut-parleur.
- Ne raccordez pas le câble de mise à la masse de cet appareil à la borne négative (-) du haut-parleur.
- Raccordez uniquement des haut-parleurs passifs. Le raccordement de haut-parleurs actifs (avec amplificateurs intégrés) aux bornes des haut-parleurs peut endommager l'appareil.
- Pour éviter tout problème de fonctionnement, n'utilisez pas les câbles des haut-parleurs intégrés installés dans votre voiture si l'appareil possède un câble négatif commun (-) pour les haut-parleurs droit et gauche.
- Ne raccordez pas vos autres câbles des haut-parleurs de l'appareil.

Remarque sur le raccordement
Si le haut-parleur et l'amplificateur ne sont pas raccordés correctement, le message « FALLURE » s'affiche. Dans ce cas, assurez-vous que les haut-parleurs et l'amplificateur sont bien raccordés.

Equipment used in illustrations (not supplied)
Appareils utilisés dans les illustrations (non fournis)

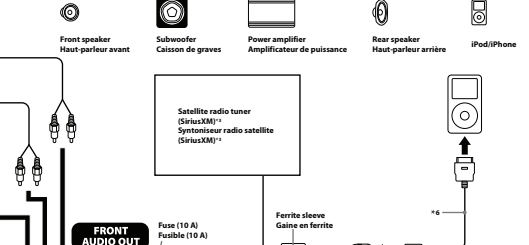

Front speaker Haut-parleur avant
Subwoofer Caisson de graves
Power amplifier Amplificateur de puissance
Rear speaker Haut-parleur arrière
iPod/iPhone

Satellite radio tuner (SiriusXM®)
Synchroniseur radio satellite (SiriusXM®)

FRONT AUDIO OUT
Fuse (10 A) Fusible (10 A)
Ferrite sleeve Gaine en ferrite

REM OUT Max. supply current 4.0 A
Courant max. fourni 4.0 A

Blue/white striped Rayé bleu/blanc
Black Noir
Orange/white striped Rayé orange/blanc ILLUMINATION
Red Rouge ACC
Yellow Jaune BATTERY

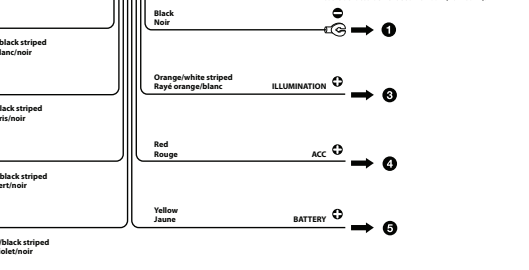

*1 RCA pin cord (not supplied).
*2 Depending on the type of car, use an adaptor for a wired remote control (not supplied).
*3 Not supplied.
*4 For details on installing the microphone, see "Installing the microphone" on the reverse side.
*5 Whether in use or not, route the microphone input cord such that it does not interfere with driving. Secure the cord with a clamp, etc. If it is installed around your feet.
*6 Use connector cable RC-100P (not supplied).
*7 Cordon à broche RCA (non fourni).
*8 Selon le type de voiture, il pourrait être nécessaire d'utiliser une télécommande câblée (non fournie).
*9 Non fourni.
*10 Pour les détails sur l'installation du microphone, référez-vous à « Installation du microphone » à ou verso.
*11 Qu'il soit en usage ou non, achenez le cordon d'entrée du microphone de telle sorte qu'il ne gêne pas votre conduite. Fixez le cordon à l'aide d'une attache, etc. s'il est installé autour de vos pieds.
*12 Câble de raccordement USB RC-100P (non fourni).

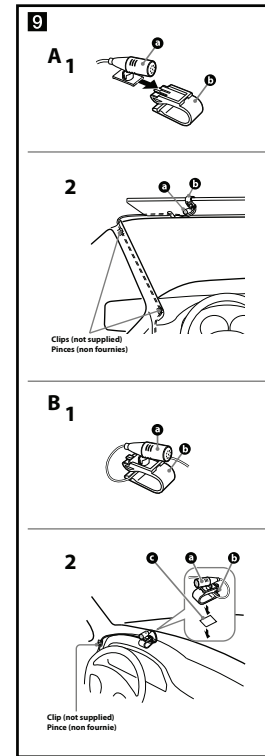
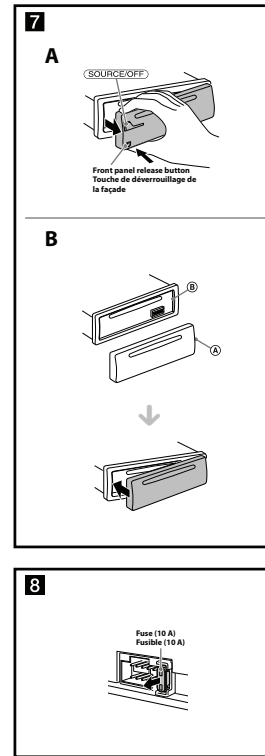
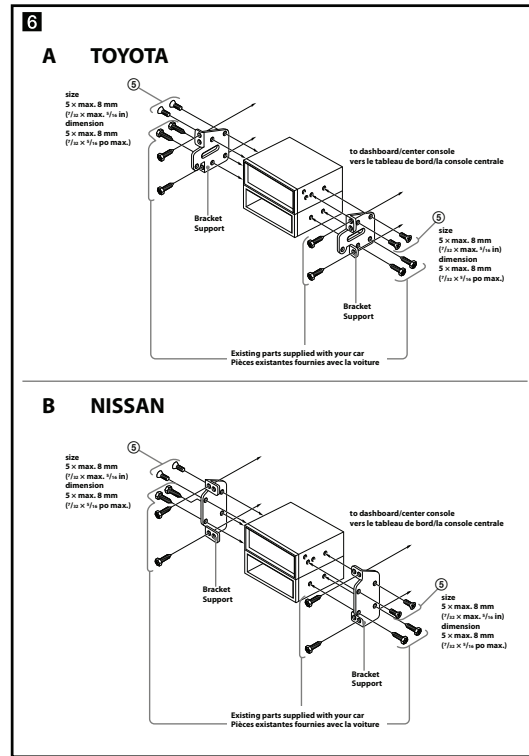
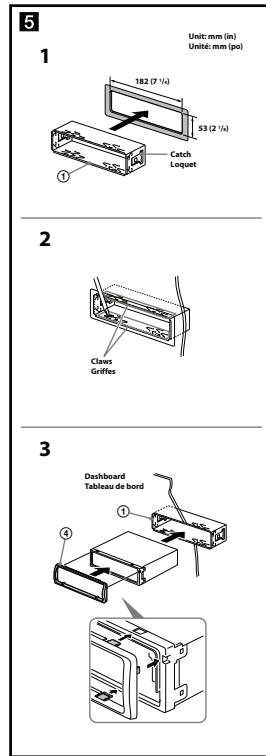
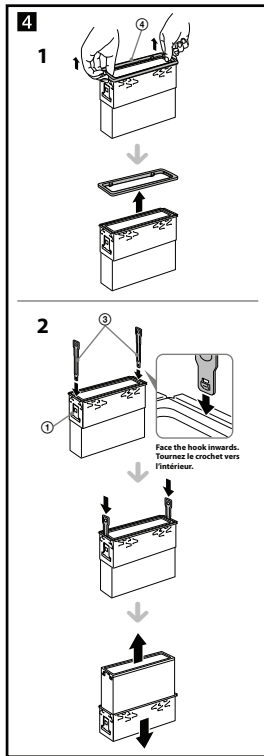

English

Precautions

- Choose the installation location carefully so that the unit will not interfere with normal driving operations.
- Avoid installing the unit in areas subject to dust, dirt, excessive vibration, or high temperatures, such as in direct sunlight or near heater ducts.
- Use only the supplied mounting hardware for a safe and secure installation.

Mounting angle adjustment
Adjust the mounting angle to less than 45°.

Removing the protection collar and the bracket (4)

Before installing the unit, remove the protection collar (4) and the bracket (1) from the unit.

- Remove the protection collar (4).
Pinch both edges of the protection collar (4), then pull it out.
- Remove the bracket (1).
Insert both release keys (1) together between the unit and the bracket (1) until they click.
Pull down the bracket (1), then pull up the unit to separate.

Mounting example (5)

Installation in the dashboard

Notes

- Before installing, make sure that the catches on both sides of the bracket (1) are bent inwards 2 mm (1/16 in). If the catches are straight, bend them inwards. The unit will not be installed securely and may spring out (1).
- Bend these claws outward for a tight fit, if necessary (2).
- Make sure that the 4 catches on the protection collar (4) are properly engaged in the slots of the unit (3).

Mounting the unit in a Japanese car (6)

You may not be able to install this unit in some makes of Japanese cars. In such a case, consult your Sony dealer.

Note
To prevent malfunction, install only with the supplied screws (5).

How to detach and attach the front panel (7)

Before installing the unit, detach the front panel.

7-A To detach
Before detaching the front panel, be sure to press and hold (SOURCE/OFF). Press the front panel release button, and pull it off towards you.

7-B To attach
Engage part (2) of the front panel with part (3) of the unit, as illustrated, and push the left side into position until it clicks.

Warning if your car's ignition has no ACC position

Be sure to set the Auto Off function. For details, see the supplied Operating Instructions.
The unit will shut off completely and automatically in the set time after the unit is turned off, which prevents battery drain.
If you do not set the Auto Off function, press and hold (SOURCE/OFF) until the display disappears each time you turn the ignition off.

Mounting the unit in a Japanese car (6)

A TOYOTA

size 5 x max. 8 mm (1/16 x max. 1/16 in)
dimension 5 x max. 8 mm (1/16 x 1/16 po max.)

to dashboard/center console vers le tableau de bord/la console centrale

Bracket Support

Existing parts supplied with your car Pièces existantes fournies avec la voiture

B NISSAN

size 5 x max. 8 mm (1/16 x max. 1/16 in)
dimension 5 x max. 8 mm (1/16 x 1/16 po max.)

to dashboard/center console vers le tableau de bord/la console centrale

Bracket Support

Existing parts supplied with your car Pièces existantes fournies avec la voiture

Fuse replacement (8)

When replacing the fuse, be sure to use one matching the amperage rating stated on the original fuse. If the fuse blows, check the power connection and replace the fuse. If the fuse blows again after replacement, there may be an internal malfunction. In such a case, consult your nearest Sony dealer.

Installing the microphone (9)

To capture your voice during handsfree calling, you need to install the microphone (supplied).

Cautions

- Keep the microphone away from extremely high temperatures and humidity.
- It is extremely dangerous if the cord becomes wound around the steering column or gearstick. Be sure to keep it and other parts from obstructing your driving.
- If airbags or any other shock-absorbing equipment is in your car, contact the store where you purchased this unit, or the car dealer, before installation.

9-A Installing on the sun visor

- Install the microphone (9) on the clip (1).
- Place the cord along the groove of the clip (1).
- Install clips (not supplied) and adjust the length and position of the cord so that it does not obstruct your driving.

9-B Installing on the dashboard

- Install the microphone (9) on the clip (1), then place the cord along the groove of the clip (1).
- Attach the clip (1) to the dashboard with the double-sided tape (2).
- Install a clip (not supplied) and adjust the length and position of the cord so that it does not obstruct your driving.

Notes

- Before attaching the double-sided tape (2), clean the surface of the dashboard with a dry cloth.
- Adjust the microphone angle to the proper position.
- The microphone (9) can be installed without using the clip (1). In this case, directly attach the microphone to the dashboard with the double-sided tape (2). Keep the unused clip (1) for future use.

Précautions

- Choisissez soigneusement l'emplacement d'installation pour que l'appareil ne gêne pas le conducteur pendant la conduite.
- Évitez d'installer l'appareil dans un endroit exposé à la poussière, à la saleté, à des vibrations excessives ou à des températures élevées comme en plein soleil ou à proximité de conduits de chauffage.
- Pour garantir un montage sûr, utilisez que le matériel fourni.

Réglage de l'angle de montage
Réglez l'inclinaison à un angle inférieur à 45°.

Retrait du tour de protection (4)

Avant d'installer l'appareil, retirez le tour de protection (4) et le support (1) de l'appareil.

- Retirez le tour de protection (4).
Pincez les deux bords du tour de protection (4), puis sortez-le.
- Retirez le support (1).
Insérez les clés de déblocage (1) en même temps entre l'appareil et le support (1) jusqu'au dé clic.
- Tirez le support (1) vers le bas, puis tirez sur l'appareil vers le haut pour le séparer.

Exemple de montage (5)

Installation dans le tableau de bord

Remarques

- Avant l'installation, assurez-vous que les boquets des deux côtés du support (1) sont bien pliés de 2 mm (1/16 po) vers l'intérieur. Si les boquets sont droits ou pliés vers l'extérieur, l'appareil ne peut pas être fixé solidement et peut se détacher (1).
- Si nécessaire, pliez ces griffes vers l'intérieur pour assurer une prise correcte (2).
- Assurez-vous que les 4 boquets situés sur le tour de protection (1) sont correctement engagés dans les fentes de l'appareil (3).

Précautions

- Choisissez soigneusement l'emplacement d'installation pour que l'appareil ne gêne pas le conducteur pendant la conduite.
- Évitez d'installer l'appareil dans un endroit exposé à la poussière, à la saleté, à des vibrations excessives ou à des températures élevées comme en plein soleil ou à proximité de conduits de chauffage.
- Pour garantir un montage sûr, utilisez que le matériel fourni.

Réglage de l'angle de montage
Réglez l'inclinaison à un angle inférieur à 45°.

Retrait du tour de protection (4)

Avant d'installer l'appareil, retirez le tour de protection (4) et le support (1) de l'appareil.

- Retirez le tour de protection (4).
Pincez les deux bords du tour de protection (4), puis sortez-le.
- Retirez le support (1).
Insérez les clés de déblocage (1) en même temps entre l'appareil et le support (1) jusqu'au dé clic.
- Tirez le support (1) vers le bas, puis tirez sur l'appareil vers le haut pour le séparer.

Exemple de montage (5)

Installation dans le tableau de bord

Remarques

- Avant l'installation, assurez-vous que les boquets des deux côtés du support (1) sont bien pliés de 2 mm (1/16 po) vers l'intérieur. Si les boquets sont droits ou pliés vers l'extérieur, l'appareil ne peut pas être fixé solidement et peut se détacher (1).
- Si nécessaire, pliez ces griffes vers l'intérieur pour assurer une prise correcte (2).
- Assurez-vous que les 4 boquets situés sur le tour de protection (1) sont correctement engagés dans les fentes de l'appareil (3).

Exemple de montage (5)

Installation dans le tableau de bord

Remarques

- Avant l'installation, assurez-vous que les boquets des deux côtés du support (1) sont bien pliés de 2 mm (1/16 po) vers l'intérieur. Si les boquets sont droits ou pliés vers l'extérieur, l'appareil ne peut pas être fixé solidement et peut se détacher (1).
- Si nécessaire, pliez ces griffes vers l'intérieur pour assurer une prise correcte (2).
- Assurez-vous que les 4 boquets situés sur le tour de protection (1) sont correctement engagés dans les fentes de l'appareil (3).

Montage de l'appareil dans une voiture japonaise (6)

Cet appareil ne peut pas être installé dans certaines voitures japonaises. Consultez, dans ce cas, votre détaillant Sony.

Remarque
Pour éviter tout problème de fonctionnement, utilisez uniquement les vis (5) fournies pour le montage.

Retrait et fixation de la façade (7)

Avant d'installer l'appareil, retirez la façade.

7-A Pour la retirer
Avant de retirer la façade, n'oubliez pas de maintenir enfoncée la touche (SOURCE/OFF). Appuyez sur la touche de déverrouillage de la façade, puis faites glisser la façade vers vous.

7-B Pour la fixer
Engagez la partie (2) de la façade dans la partie (3) de l'appareil, comme illustré, puis appuyez sur le côté gauche jusqu'à dé clic indiquant que la façade est en position.

Avertissement si le contact de votre véhicule ne comporte pas de position ACC

Veillez à régler la fonction Auto Off. Pour obtenir davantage d'informations, reportez-vous au mode d'emploi fourni.
L'appareil s'éteint complètement et automatiquement après le laps de temps choisi une fois l'appareil arrêté afin d'éviter que la batterie ne se décharge.
Si vous ne réglez pas la fonction Auto Off, appuyez sur la touche (SOURCE/OFF) et maintenez-la enfoncée jusqu'à ce que l'icône disparaisse à chaque fois que vous coupez le contact.

Avertissement si le contact de votre véhicule ne comporte pas de position ACC

Veillez à régler la fonction Auto Off. Pour obtenir davantage d'informations, reportez-vous au mode d'emploi fourni.
L'appareil s'éteint complètement et automatiquement après le laps de temps choisi une fois l'appareil arrêté afin d'éviter que la batterie ne se décharge.
Si vous ne réglez pas la fonction Auto Off, appuyez sur la touche (SOURCE/OFF) et maintenez-la enfoncée jusqu'à ce que l'icône disparaisse à chaque fois que vous coupez le contact.

Remplacement du fusible (8)

Lorsque vous remplacez le fusible, veillez à utiliser un fusible dont l'intensité, en ampères, correspond à la valeur indiquée sur le fusible usagé. Si le fusible grille, vérifiez le branchement de l'alimentation et remplacez le fusible. Si le nouveau fusible grille également, il est possible que l'appareil soit défectueux. Dans ce cas, consultez votre détaillant Sony le plus proche.

Installation du microphone (9)

Pour capturer votre voix au cours d'un appel en mains libres, vous devez installer le microphone (fourni).

Avertissements

- Éloignez le microphone de l'humidité et des températures extrêmement élevées.
- Il est extrêmement dangereux que le cordon s'enroule autour de la colonne de direction ou du levier de vitesses. Assurez-vous d'éviter que le cordon et les autres parties puissent encombrer votre conduite.
- Si des coussins gonflables ou tout équipement antichoc se trouvent dans votre voiture, communiquez avec le magasin où vous avez acheté cet appareil, ou le concessionnaire, avant l'installation.

9-A Installation sur le pare-soleil

- Installez le microphone (9) sur la pince (1).
- Installez la pince (1) sur le pare-soleil.
- Installez les pinces (non fournies) et réglez la longueur et la position du cordon de façon à ne pas encombrer votre conduite.

9-B Installation sur le tableau de bord

- Installez le microphone (9) sur la pince (1).
- Placez le cordon le long de la rainure de la pince (1).
- Fixez la pince (1) au tableau de bord à l'aide d'un ruban adhésif à double face (2).
- Installez la pince (non fournie) et réglez la longueur et la position du cordon de façon à ne pas encombrer votre conduite.

Remarques

- Avant de fixer le ruban adhésif à double face (2), nettoyez la surface du tableau de bord avec un tissu sec.
- Régler l'angle du microphone à la bonne position.
- Le microphone (9) peut être installé sans utiliser la pince (1).
- Le cas échéant, fixez directement le microphone au tableau de bord à l'aide d'un ruban adhésif à double face (2). Gardez la pince inutilisée (1) pour utilisation ultérieure.

Remarques

- Avant de fixer le ruban adhésif à double face (2), nettoyez la surface du tableau de bord avec un tissu sec.
- Régler l'angle du microphone à la bonne position.
- Le microphone (9) peut être installé sans utiliser la pince (1).
- Le cas échéant, fixez directement le microphone au tableau de bord à l'aide d'un ruban adhésif à double face (2). Gardez la pince inutilisée (1) pour utilisation ultérieure.

SONY®

For Dealers

For display purposes it is necessary to secure the front panel to the unit as shown below.

Secure the screw on the left side of the unit.

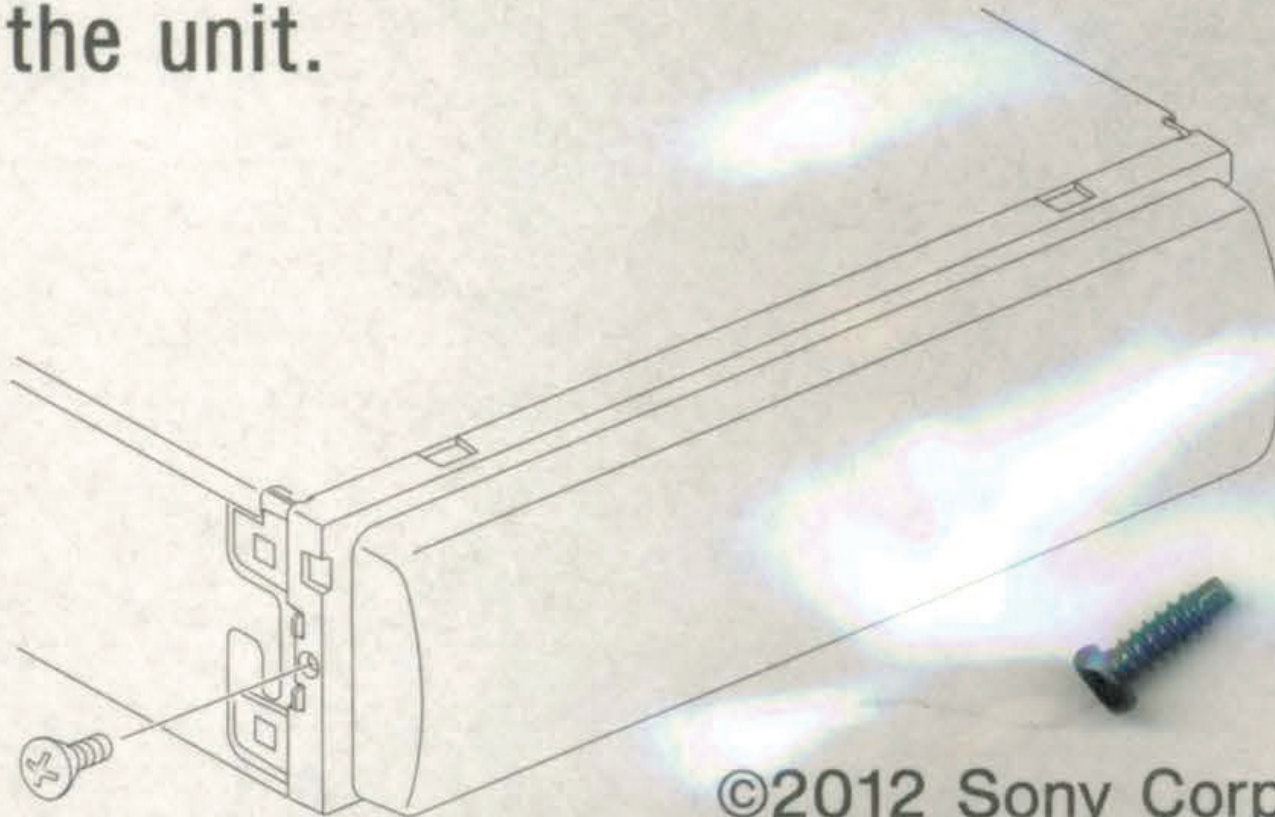

©2012 Sony Corporation

Printed in Thailand

SONY®

Garantie d'un an protégeant les consommateurs

Sony du Canada Ltée (Sony), sous réserve des modalités et conditions indiquées aux présentes, garantit le présent produit contre tout défaut de fabrication ou toute défaillance des matériaux entrant dans sa fabrication pour la période de garantie spécifiée. Si un défaut de fabrication ou une défaillance des matériaux survient pendant la période de garantie spécifiée, Sony veillera à réparer le produit en y effectuant tous les remplacements de pièces nécessaires par des pièces neuves ou remises à neuf et ce, sans frais quant aux pièces ou à la main-d'œuvre.

La période de garantie est la suivante :

Main-d'œuvre et pièces : UN an à compter de la date d'achat originelle au détail.

Conditions :

Modifications, réparations, abus non autorisés, etc. :

La présente garantie limitée est nulle si : (i) l'unité a été altérée, modifiée ou installée aux fins d'usage commercial, ou réparée ou entretenue par une personne autre qu'un centre de réparation autorisé par Sony afin d'effectuer de tels services. (ii) le numéro de série de l'unité a été altéré ou retiré, ou (iii) l'unité a subi un accident, un mauvais usage, un abus ou a été utilisée pour un usage contraire aux directives du mode d'emploi. L'opinion de Sony à cet effet est sans appel.

Usage commercial ou location :

Ce produit n'est pas conçu pour usage commercial ou location. Advenant que cette unité soit utilisée à des fins commerciales ou comme unité en location, la période de garantie limitée pour les pièces et la main-d'œuvre est réduite à 90 jours après la date d'achat originelle. L'opinion de Sony à cet effet est sans appel.

Exclusions :

La présente garantie limitée exclut les armoires, accessoires ou piles brisés ou endommagés; les antennes et stylets exposés, ou la défaillance de pièces découlant de leur usure normale. La présente garantie limitée exclut l'entretien régulier des produits, tels que le nettoyage, la lubrification ou les vérifications.

La présente garantie limitée ne couvre que l'équipement fourni avec le produit. Elle ne couvre aucune assistance technique quant à l'usage d'équipement ou de logiciel et ne couvre aucun logiciel, fourni ou non avec le produit. De tels logiciels sont fournis « TELS QUELS », sauf aux termes d'une garantie limitée de logiciel comprise dans l'emballage. Veuillez consulter les ententes d'usage comprises avec le produit pour connaître vos droits et obligations relativement aux logiciels.

La présente garantie n'est valide qu'au Canada.

Livraison :

L'unité doit être livrée en personne à l'un des centres de réparation Sony du Canada, ou expédiée, dans son emballage d'origine ou un emballage équivalent accordant un niveau de protection équivalent, ainsi que des directives indiquant l'emplacement au Canada où l'unité peut être retournée. Si l'unité est expédiée à un centre de réparation, l'unité réparée sera retournée au client port payé. Tous les accessoires compris avec l'unité doivent être énumérés individuellement sur le bordereau d'expédition aux fins de documentation d'expédition. Les accessoires défectueux doivent être expédiés à Sony à titre d'article distinct à réparer. Sony n'est pas responsable des pertes ou dommages des articles en transit expédiés aux centres de réparation. Toute pièce remplacée aux termes de la présente garantie limitée devient la propriété de Sony. **Vous êtes responsable de faire une copie de sauvegarde de toutes données, logiciels ou autres que vous auriez pu stocker ou conserver sur votre unité. Il est fort probable que des données, logiciels ou autres seront perdus ou reformatés pendant la réparation, et Sony n'est pas responsable de tels dommages ou pertes.**

Preuve d'achat :

La présente garantie limitée s'applique au produit à compter de la date d'achat originelle au détail. Par conséquent, le propriétaire doit présenter une preuve d'achat originelle au détail.

Produit visés par la présente garantie :

La présente garantie limitée s'applique aux produits Sony suivants, et peut aussi s'appliquer à d'autres produits s'ils font partie de l'emballage d'origine du produit :

Accessoires audio / vidéo
Produits audio / vidéo pour l'automobile
Caméras vidéo et accessoires connexes
Caméras photos numériques de type Cyber-shot® et accessoires connexes
Radios-réveil munis d'un lecteur CD
Lecteurs numériques de médias/Lecteurs numériques de musique
Imprimantes / scanners de photos numérisées
Enregistreurs numériques de la parole
Enregistreurs numériques à circuits intégrés
Systèmes audio pour la maison
Systèmes de cinéma-maison
Lecteurs et enregistreurs vidéo pour la maison
Produits de navigation mobile
Magnétophones à microcassettes
Baladeurs Net MD/H-MMD
Baladeurs réseau
Lecteurs CD portables / munis d'un récepteur radio
Lecteurs DVD portables
Radios portables de type « casque d'écoute stéréo »
Enregistreurs/lecteurs portables à MiniDisques
Radios portables et lecteurs CD / avec lecteur cassettes
Radios portables
Récepteurs-enregistreurs radiophoniques combinés
Magnétoscopes à cassettes et accessoires connexes
Baladeurs vidéo

SAUF DANS LA MESURE OÙ LA LOI APPLICABLE L'INTERDIT, TOUTES LES AUTRES GARANTIES ET CONDITIONS, EXPRESSES OU IMPLICITES, RELLEVANT OU NON D'UNE LOI, D'UN ACTE LÉGISLATIF, D'HABITUDES COMMERCIALES ÉTABLIES OU D'USAGES DU COMMERCE, Y COMPRIS, NOTAMMENT, TOUTE GARANTIE IMPLICITE DE QUALITÉ MARCHANDE OU DE L'ADAPTABILITÉ À UNE FIN PARTICULIÈRE, SONT DÉSAVOUÉES. SONY NE SAURAIT EN AUCUN CAS ÊTRE RESPONSABLE D'UN MONTANT SUPÉRIEUR AU PRIX RÉEL D'ACHAT DU PRODUIT; ET SONY NE SAURAIT EN AUCUN CAS ÊTRE RESPONSABLE DE DOMMAGES SPÉCIAUX, ACCESSOIRES OU CONSÉCUTIFS SUBIS RELATIVEMENT AU PRODUIT. SONY N'ASSUME NI N'AUTORISE AUCUN REPRÉSENTANT OU QUICONQUE À ASSUMER EN SON NOM UNE OBLIGATION OU RESPONSABILITÉ AUTRE QUE CELLES QUI SONT EXPRESSÉMENT DÉCRITES AUX PRÉSENTES. L'EXCLUSION DE GARANTIES ET CONDITIONS IMPLICITES N'EST PAS AUTORISÉE DANS CERTAINS TERRITOIRES.

Enregistrement du produit :

Merci d'avoir choisi un produit Sony. Chez Sony, nous nous efforçons de créer des produits de la plus haute qualité afin de renforcer votre expérience et votre satisfaction. Afin d'assurer le meilleur soutien qui soit à votre produit, nous vous demandons de remplir une fiche d'enregistrement de produit sur le site www.fr.SonyStyle.ca/enregistrement dans les quatre-vingt-dix (90) jours suivant la date d'achat.

Pour obtenir de l'aide concernant le service ou obtenir des renseignements sur le produit ou concernant l'enregistrement du produit, veuillez appeler le 1-877-899-7669. Pour obtenir des renseignements concernant la garantie prolongée Sony Care, veuillez appeler le 1-800-773-9667.

Pour le support technique et les mises à jour en ligne en tout temps, vous pouvez visiter le

www.fr.sony.ca/sonyca/view/french/support_electronics.shtml

ou appeler le Centre d'information à la clientèle Sony au 1-877-899-7669.



Consumer 1 Year Warranty

Sony of Canada Ltd. ("Sony") hereby warrants, subject to the terms and conditions herein set forth, this product against defects in material and workmanship during the specified warranty period. In the event of a defect of material or workmanship during the specified warranty period, Sony will repair the same, effecting all necessary parts replacements with either new or refurbished parts, without charge for either parts or labour.

The warranty period is as follows:

Labour and Parts: ONE year from the date of original purchase at retail.

Conditions:

Unauthorized Modification, Repair, Abuse, Etc.:

This limited warranty is void if: (i) the unit has been previously altered, modified, installed or mounted for commercial use, or repaired or serviced by anyone other than the service facilities authorized by Sony to render such services, (ii) the serial number on the unit has been altered or removed, or (iii) the unit has been subject to accident, misuse, abuse or operated contrary to the instructions contained in the Owner's Manual. The opinion of Sony with respect to this matter shall be final.

Commercial Use or Rental:

This product is not intended for commercial use or rental. Should this unit be used at any time for commercial purposes or as a rental unit, the limited warranty period for parts and labour shall be 90 days from the date of original purchase at retail. The opinion of Sony with respect to this matter shall be final.

Exclusions:

This limited warranty does not extend to broken or damaged cabinets, accessories, batteries, exposed antennas and styluses, or to parts wearing out due to normal wear and tear. This limited warranty does not cover regular product maintenance such as cleaning, lubrication or check-ups.

This limited warranty covers only the hardware components packaged with the product. It does not cover technical assistance for hardware or software usage and it does not cover any software products whether or not contained in the product. Any such software is provided "AS IS" unless expressly provided for in any enclosed software limited warranty. Please refer to the End User License Agreements included with the product for your rights and obligations with respect to the software.

This limited warranty is valid only in Canada.

Delivery:

The unit must be delivered in person to one of the nearest Sony service facilities in Canada, or shipped, freight prepaid, in either its original package or similar package affording an equal degree of protection and with instructions indicating a location within Canada to which the unit may be returned. If shipped to the service facility, the repaired unit will be returned to customer freight prepaid. All accessories that are enclosed with the unit must be listed individually on the packing slip for the shipping documentation. Defective accessories should be shipped to Sony as a separate repair item. Sony shall have no liability whatsoever for loss or damage in transit of items shipped to service facilities. Any parts replaced under this limited warranty will become the property of Sony. **It is your responsibility to back up any data, software or other materials you may have stored or preserved on your unit. It is likely that such data, software, or other materials will be lost or reformatted during service and Sony will not be responsible for any such damage or loss.**

Proof of Purchase:

This limited warranty applies to the product from the original date of purchase at retail. The owner must furnish proof of original purchase at retail.

Subject Products:

This limited warranty is applicable to the following Sony Products, and may also be applicable to other Sony products if enclosed in the product's original packaging:

Audio/Video Accessories
Car Audio/Video Products
Camcorders and related accessories
Cyber-shot® Digital still Camera and related accessories
Clock Radio/with CD Players
Digital Media Players/ Digital Music Players
Digital Photo Printers/Scanners
Digital Voice Recorder
IC Chip Recorders
Home Audio Systems
Home Theatre System
Home Video Player and Recorders
Mobile Navigation Products
Microcassette recorder
Net MD/H-MMD Walkman
Network Walkman
Portable CD Players/ with Radio
Portable DVD Players
Portable Headset Stereo Radios
Portable MiniDisc Recorder/Players
Portable Radio CD Players /with Cassette
Portable Radio
Radio Cassette Combinations
Video Cassette Recorders and related accessories
Video Walkman

EXCEPT TO THE EXTENT PROHIBITED BY APPLICABLE LAW, ALL OTHER WARRANTIES AND CONDITIONS, EXPRESS OR IMPLIED, WHETHER ARISING BY LAW, BY STATUTE, BY COURSE OF DEALING OR USAGE OF TRADE, INCLUDING WITHOUT LIMITATION IMPLIED WARRANTIES OF MERCHANTABILITY, MERCHANTABILITY AND FITNESS FOR A PARTICULAR PURPOSE ARE DISCLAIMED. UNDER NO CIRCUMSTANCES SHALL SONY BE LIABLE FOR AN AMOUNT GREATER THAN THE ACTUAL PURCHASE PRICE OF THE UNIT OR FOR ANY SPECIAL, INCIDENTAL OR CONSEQUENTIAL DAMAGES SUSTAINED IN CONNECTION WITH SAID UNIT AND SONY NEITHER ASSUMES NOR AUTHORIZES ANY REPRESENTATIVE OR OTHER PERSON TO ASSUME FOR IT ANY OBLIGATION OR LIABILITY OTHER THAN SUCH AS IS EXPRESSLY SET FORTH HEREIN. SOME JURISDICTIONS DO NOT ALLOW THE EXCLUSION OF IMPLIED WARRANTIES AND CONDITIONS.

Product Registration:

Thank you for choosing a Sony product. At Sony, we strive to create products of the highest quality to enhance your experience and enjoyment. To provide the best support for your product, we request that you complete a product registration form at www.SonyStyle.ca/registration within 90 days of purchase.

For service assistance, product information, or product registration please call: 1-877-899-7669. For information about a Sony Care Extended Warranty, please call 1-800-773-9667.

For online product support and updates at any time, please visit:
www.sony.ca/sonyca/view/english/support_electronics.shtml,
or call the Sony Customer Information Centre at 1-877-899-7669.

SONY®

Car Audio

LIMITED WARRANTY (U.S. Only)

Sony Electronics Inc. ("Sony") warrants this product against defects in material or workmanship for the time periods and as set forth below when purchased directly from Sony or a Sony Retailer. Pursuant to this Limited Warranty, Sony will, at its option, (i) repair the product using new or refurbished parts or (ii) replace the product with a new or refurbished product. For purposes of this Limited Warranty, "refurbished" means a product or part that has been returned to its original specifications. **In the event of a defect, these are your exclusive remedies.**

Labor: For a period of three (3) years from the original date of purchase of the product ("Labor Warranty"), Sony will, at its option, repair or replace with new or refurbished product, product determined to be defective. If Sony elects to replace the product after this Labor Warranty has expired but while the Parts Warranty below is still in effect, it will do so for the applicable labor charge.

Parts: For a period of three (3) years from the original date of purchase of product ("Parts Warranty"), Sony will supply new or refurbished replacement parts in exchange for parts determined to be defective.

This Limited Warranty covers only the hardware components packaged with the Product. It does not cover technical assistance for hardware or software usage and it does not cover any software products whether or not contained in the Product; any such software is provided "AS IS" unless expressly provided for in any enclosed software Limited Warranty. Please refer to the End User License Agreements included with the Product for your rights and obligations with respect to the software.

Instructions: To obtain warranty service, you must deliver the product, freight prepaid, in either its original packaging or packaging affording an equal degree of protection to the Sony authorized service facility specified. **It is your responsibility to backup any data, software or other materials you may have stored or preserved on your unit. It is likely that such data, software, or other materials will be lost or reformatted during service and Sony will not be responsible for any such damage or loss.** A dated purchase receipt from Sony or a Sony Retailer is required. For specific instructions on how to obtain warranty service for your product,

Visit Sony's Web Site:
www.sony.com/support

Or call the **Sony Customer Information Service Center**
1-800-222-SONY(7669)

For an accessory or part not available from your authorized dealer, call:

1-800-488-SONY (7669)

Repair / Replacement Warranty: This Limited Warranty shall apply to any repair, replacement part or replacement product for the remainder of the original Limited Warranty period or for ninety (90) days, whichever is longer. Any parts or product replaced under this Limited Warranty will become the property of Sony.

This Limited Warranty only covers product issues caused by defects in material or workmanship during ordinary consumer use; it does not cover product issues caused by any other reason, including but not limited to product issues due to commercial use, acts of God, misuse, limitations of technology, or modification of or to any part of the Sony product or product purchased from other than Sony or a Sony Retailer. To determine if a retailer is part of the Sony Retailer Network, please contact Sony's Customer Service Call Center or go to www.sony.com/support. This Limited Warranty does not cover Sony products sold AS IS or WITH ALL FAULTS or consumables (such as fuses or batteries). This Limited Warranty is invalid if the factory-applied serial number has been altered or removed from the product. This Limited Warranty is valid only in the United States.

LIMITATION ON DAMAGES: SONY SHALL NOT BE LIABLE FOR ANY INCIDENTAL OR CONSEQUENTIAL DAMAGES FOR BREACH OF ANY EXPRESS OR IMPLIED WARRANTY ON THIS PRODUCT.

DURATION OF IMPLIED WARRANTIES: EXCEPT TO THE EXTENT PROHIBITED BY APPLICABLE LAW, ANY IMPLIED WARRANTY OF MERCHANTABILITY OR FITNESS FOR A PARTICULAR PURPOSE ON THIS PRODUCT IS LIMITED IN DURATION TO THE DURATION OF THIS WARRANTY.

Some states do not allow the exclusion or limitation of incidental or consequential damages, or allow limitations on how long an implied warranty lasts, so the above limitations or exclusions may not apply to you. This Limited Warranty gives you specific legal rights and you may have other rights which vary from state to state.